

NATIONAL REGISTER OF HISTORIC PLACES  
INVENTORY - NOMINATION FORM

(Type all entries - complete applicable sections)

|                      |      |
|----------------------|------|
| STATE:<br>Missouri   |      |
| COUNTY:<br>Lafayette |      |
| FOR NPS USE ONLY     |      |
| ENTRY NUMBER         | DATE |
| 1                    |      |

1. NAME

COMMON:  
Anderson House and Lexington Battlefield

AND/OR HISTORIC:  
Colonel Oliver Anderson House

2. LOCATION

STREET AND NUMBER:  
Sections 27 and 28, Township 51N, Range 27W

CITY OR TOWN:  
Lexington

STATE: Missouri CODE: 2h COUNTY: Lafayette CODE: 107

3. CLASSIFICATION

| CATEGORY<br>(Check One)  | OWNERSHIP                                  |  |   | STATUS   | ACCESSIBLE<br>TO THE PUBLIC |
|--|--|--|---|--|-----------------------------|
| District <input type="checkbox"/> Building <input checked="" type="checkbox"/> | Public <input checked="" type="checkbox"/> | Public Acquisition: <input type="checkbox"/> | Occupied <input type="checkbox"/>                         | Yes:   |                             |
| Site <input checked="" type="checkbox"/> Structure <input type="checkbox"/>    | Private <input type="checkbox"/>           | In Process <input type="checkbox"/>          | Unoccupied <input checked="" type="checkbox"/>            | Restricted <input checked="" type="checkbox"/> |                             |
| Object <input type="checkbox"/>  | Both <input type="checkbox"/>              | Being Considered <input type="checkbox"/>    | Preservation work<br>in progress <input type="checkbox"/> | Unrestricted <input type="checkbox"/>          |                             |
| PRESENT USE (Check One or More as Appropriate)                                 |  |  |   |  |                             |
| Agricultural <input type="checkbox"/>  | Government <input type="checkbox"/>        | Park <input checked="" type="checkbox"/>     | Transportation <input type="checkbox"/>                   | Comments <input type="checkbox"/>              |                             |
| Commercial <input type="checkbox"/>  | Industrial <input type="checkbox"/>        | Private Residence <input type="checkbox"/>   | Other (Specify) <input type="checkbox"/>                  |  |                             |
| Educational <input type="checkbox"/>   | Military <input type="checkbox"/>          | Religious <input type="checkbox"/>           |   |  |                             |
| Entertainment <input type="checkbox"/>   | Museum <input type="checkbox"/>            | Scientific <input type="checkbox"/>          |   |  |                             |

4. OWNER OF PROPERTY

OWNERS NAME:  
State of Missouri

STREET AND NUMBER:  
Missouri State Park Board  
P.O. Box 176, 120h Jefferson Building

CITY OR TOWN:  
Jefferson City

STATE: Missouri CODE: 2h

5. LOCATION OF LEGAL DESCRIPTION

COURTHOUSE, REGISTRY OF DEEDS, ETC.:  
County Recorder's Office

STREET AND NUMBER:

CITY OR TOWN:  
Lexington

STATE: Missouri CODE: 2h

APPROXIMATE ACREAGE OF NOMINATED PROPERTY: 90

6. REPRESENTATION IN EXISTING SURVEYS

TITLE OF SURVEY:  
Missouri Historic Sites Catalogue

DATE OF SURVEY: 1963 Federal  State  County  Local

DEPOSITORY FOR SURVEY RECORDS:  
State Historical Society of Missouri

STREET AND NUMBER:  
Corner, Hitt and Lowry streets

CITY OR TOWN:  
Columbia

STATE: Missouri CODE: 2h

SEE INSTRUCTIONS

STATE: Missouri  
COUNTY: Lafayette  
ENTRY NUMBER: 1  
DATE: 1963  
FOR NPS USE ONLY

7. DESCRIPTION

|           |   |  |                               |                                       |   |                                    |
|-----------|---|--|-------------------------------|---------------------------------------|---|------------------------------------|
| CONDITION | (Check One)                                 |  |                               |                                       |   |                                    |
|           | Excellent <input type="checkbox"/>          | Good <input checked="" type="checkbox"/> | Fair <input type="checkbox"/> | Deteriorated <input type="checkbox"/> | Ruins <input type="checkbox"/>                    | Unexposed <input type="checkbox"/> |
| INTEGRITY | (Check One)                                 |  |                               | (Check One)                           |   |                                    |
|           | Altered <input checked="" type="checkbox"/> | Unaltered <input type="checkbox"/>       |                               | Moved <input type="checkbox"/>        | Original Site <input checked="" type="checkbox"/> |                                    |

DESCRIBE THE PRESENT AND ORIGINAL (If known) PHYSICAL APPEARANCE

Two and one-half story brick house facing west with two story brick ell projecting from the east (rear) wall. Ell north wall is a slightly inset continuation of north wall of main block. Built 1853 with slave labor.

A late example of the Federal style house in Missouri with some features showing innovative mid-nineteenth century details. Traditional in basic form having rectangular block under ridge roof, symmetrical facade. A width of five bays expresses interior plan of large central hallway flanked on both sides by two rooms (one in front and one behind).

Stone foundation. Facade brick work notable as is laid up entirely in stretcher courses with no headers, a departure from the more typical English bond of Missouri houses of this period.

Double chimneys on top of each main block gable wall with modest brick courses ornamenting the top of the stacks.

Broad wooden Federal style cornice appropriately without dentil courses or brackets. Windows and doors vertically proportioned with cast iron sills and lintels. Cast iron capitols in a modified Corinthian order on front porch columns. (See accompanying photographs). Use of cast iron shows knowledge by the builder of period building art developments.

One story front porch at center of facade has balcony above which is accessible through doorway at west end of second floor central hall. Front porch may be a later addition as it was not included in an early engraving of the Battle of Lexington. However, as other details of the house are incorrect in this view, its reliability is questionable. (Frank Leslie's Illustrated Newspaper, October 12, 1861.) On rear of house and portion of ell there is a two story wooden gallery.

Interior is surprisingly spacious. Fireplaces are open in each of the eight rooms of main block of house. Stairway, "U" in plan, at rear of central hallway gives access both to second floor and attic. Native black walnut woodwork throughout. Interior partition walls are of brick construction, 13 1/2-14 inches thick.

House suffered minor damage when used as a field hospital during the Battle of Lexington, September 19, 20, 21, 1861. Many bullet holes are in evidence.

SEE INSTRUCTIONS

SEE INSTRUCTIONS

| 8. SIGNIFICANCE   |  |  |   |  |
|---|--|--|---|--|
| <b>PERIOD (Check One or More as Appropriate)</b>  |  |  |   |  |
| Pre-Columbian <input type="checkbox"/>  | 16th Century <input type="checkbox"/>        | 18th Century <input type="checkbox"/>            | 20th Century <input type="checkbox"/>               |  |
| 15th Century <input type="checkbox"/>   | 17th Century <input type="checkbox"/>        | 19th Century <input checked="" type="checkbox"/> |   |  |
| <b>SPECIFIC DATE(S) (If Applicable and Known)</b>   |  |  |   |  |
| <b>AREAS OF SIGNIFICANCE (Check One or More as Appropriate)</b>   |  |  |   |  |
| Aboriginal <input type="checkbox"/>   | Education <input type="checkbox"/>           | Political <input type="checkbox"/>               | Urban Planning <input type="checkbox"/>             |  |
| Prehistoric <input type="checkbox"/>  | Engineering <input type="checkbox"/>         | Religion/Philosophy <input type="checkbox"/>     | Other (Specify) <input checked="" type="checkbox"/> |  |
| Historic <input type="checkbox"/>   | Industry <input type="checkbox"/>            | Science <input type="checkbox"/>                 | <u>Architecture</u>                                 |  |
| Agriculture <input type="checkbox"/>  | Invention <input type="checkbox"/>           | Sculpture <input type="checkbox"/>               | _____   |  |
| Art <input type="checkbox"/>  | Landscape <input type="checkbox"/>           | Social/Humanitarian <input type="checkbox"/>     | _____   |  |
| Commerce <input type="checkbox"/>   | Architecture <input type="checkbox"/>        | Theater <input type="checkbox"/>                 | _____   |  |
| Communications <input type="checkbox"/>   | Literature <input type="checkbox"/>          | Transportation <input type="checkbox"/>          | _____   |  |
| Conservation <input type="checkbox"/>   | Military <input checked="" type="checkbox"/> |  | _____   |  |
|   | Music <input type="checkbox"/>               |  | _____   |  |
| <b>STATEMENT OF SIGNIFICANCE (Include Personages, Dates, Events, Etc.)</b>  |  |  |   |  |
| <p>The Anderson House, which overlooks the Missouri River, was built in 1853 by Colonel Oliver Anderson, a native of Lexington, Kentucky. Anderson, who came to Missouri in 1851, established a rope and bag manufactory which processed the locally grown hemp.</p> <p>At the outbreak of the Civil War, all inhabitants of Missouri were required to take an oath of allegiance to the United States. Because of his Southern heritage, Col. Anderson refused to take the oath and was imprisoned by the Federal troops. His house and property were confiscated.</p> <p>Lexington, a strategically located river town, was under the Union command of Col. James Mulligan. Confederate General Sterling Price planned to capture Lexington, cut off the Federal water route to Kansas and secure more recruits from northern Missouri. This area had been cut off by the Federal control of the Missouri River.</p> <p>During the Battle of Lexington, September 18, 19, 20, 1861, the Anderson House was used as a field hospital by both the Union and Confederate forces. The hospital changed hands three times during the three-day battle. Interior and exterior of house show battle scars incurred during the fighting.</p> <p>Most of the battle was fought on an adjoining hilltop approximately <math>\frac{1}{4}</math> mile from the Anderson House. Mulligan fortified his headquarters within the Masonic College located on this hill. Mulligan ordered the construction of earthen trenches to encircle the college.</p> <p>General Price successfully laid siege to the entrenched Union troops and within three days forced their surrender. Battle is often referred to as the Battle of the Hemp Bales. Price made use of the hemp bales manufactured by Col. Anderson as breast-works for his men as they ascended the hill toward the Federal troops.</p> <p>House and battlefield are historically significant as one of Missouri's few Civil War Battle sites remaining almost entirely intact.</p> |  |  |   |  |

**9. MAJOR BIBLIOGRAPHICAL REFERENCES**

1. State Historical Society of Missouri's Historic Sites File, ref. Lafayette County.
2. Meyer, Duane. The Heritage of Missouri: A History, (St. Louis: State Publishing Co., Inc. 1965), pp. 373-374.

**10. GEOGRAPHICAL DATA**

| LATITUDE AND LONGITUDE COORDINATES<br>DEFINING A RECTANGLE LOCATING THE PROPERTY |                         |                         | O<br>R | LATITUDE AND LONGITUDE COORDINATES<br>DEFINING THE CENTER POINT OF A PROPERTY<br>OF LESS THAN ONE ACRE |           |         |
|--|-------------------------|-------------------------|--------|--|-----------|---------|
| CORNER   | LATITUDE                | LONGITUDE               |        | LATITUDE   | LONGITUDE |         |
|  | Degrees Minutes Seconds | Degrees Minutes Seconds |        | Degrees  | Minutes   | Seconds |
| NW   | 39° 11' 44"             | 93° 52' 57"             |        | °  | '         | "       |
| NE   | 39° 11' 44"             | 93° 52' 34"             |        | °  | '         | "       |
| SE   | 39° 11' 25"             | 93° 52' 34"             |        | °  | '         | "       |
| SW   | 39° 11' 25"             | 93° 52' 58"             |        | °  | '         | "       |

LIST ALL STATES AND COUNTIES FOR PROPERTIES OVERLAPPING STATE OR COUNTY BOUNDARIES

| STATE: | CODE | COUNTY  | CODE |
|--------|------|---------|------|
|        |      |         |      |
| STATE: | CODE | COUNTY: | CODE |
|        |      |         |      |
| STATE: | CODE | COUNTY: | CODE |
|        |      |         |      |
| STATE: | CODE | COUNTY: | CODE |
|        |      |         |      |

**11. FORM PREPARED BY**

NAME AND TITLE:  
Martha L. Kusiak, Research Historian

ORGANIZATION: State Historical Survey and Planning Office DATE: April 4, 1969  
Missouri State Park Board

STREET AND NUMBER:  
P.O. Box 176, 1204 Jefferson Building

CITY OR TOWN: Jefferson City STATE: Missouri 65101 CODE: 2h

**12. STATE LIAISON OFFICER CERTIFICATION**

As the designated State Liaison Officer for the National Historic Preservation Act of 1966 (Public Law 89-665), I hereby nominate this property for inclusion in the National Register and certify that it has been evaluated according to the criteria and procedures set forth by the National Park Service. The recommended level of significance of this nomination is:

National  State  Local

Name Joseph Jaeger, Jr.

Title Director, Missouri State Park Board, and Missouri State Liaison Officer

Date \_\_\_\_\_

**NATIONAL REGISTER VERIFICATION**

I hereby certify that this property is included in the National Register.

\_\_\_\_\_  
*Chief, Office of Archeology and Historic Preservation*

Date \_\_\_\_\_

ATTEST:

\_\_\_\_\_  
*Keeper of The National Register*

Date \_\_\_\_\_

SEE INSTRUCTIONS

NATIONAL REGISTER OF HISTORIC PLACES  
INVENTORY - NOMINATION FORM

(Continuation Sheet)

|                  |      |
|------------------|------|
| STATE            |      |
| Missouri         |      |
| COUNTY           |      |
| Lafayette        |      |
| FOR NPS USE ONLY |      |
| ENTRY NUMBER     | DATE |
|                  |      |

(Number all entries)

ANDERSON HOUSE AND LEXINGTON BATTLEFIELD

2.

Bounded on the west by 10th Street, on the northwest by Missouri Pacific Railroad, on the south by Utah and Wood streets and on the east by the continuation of 15th Street.

NATIONAL REGISTER OF HISTORIC PLACES  
INVENTORY - NOMINATION FORM

(Continuation Sheet)

|                  |      |
|------------------|------|
| STATE            |      |
| Missouri         |      |
| COUNTY           |      |
| Lafayette        |      |
| FOR NPS USE ONLY |      |
| ENTRY NUMBER     | DATE |
|                  |      |

(Number all entries)

ANDERSON HOUSE AND LEXINGTON BATTLEFIELD

6. Missouri State Historical Survey (state)

1968

Missouri State Park Board

P.O. Box 176

1204 Jefferson Building

Jefferson City, Missouri 65101

Code: 24

Historic American Buildings Survey (federal)

1940

Office of Archeology and Historic Preservation

National Park Service

801 19th Street, N.W.

Washington, D.C. 20006

Code: 00

NATIONAL REGISTER OF HISTORIC PLACES  
INVENTORY - NOMINATION FORM

(Continuation Sheet)

|                  |      |
|------------------|------|
| STATE            |      |
| Missouri         |      |
| COUNTY           |      |
| Lafayette        |      |
| FOR NPS USE ONLY |      |
| ENTRY NUMBER     | DATE |
|                  |      |

(Number all entries)

ANDERSON HOUSE AND LEXINGTON BATTLEFIELD

7. House suffered neglect 1923-1925. Repaired 1933-1934 as a WPA project. During 1955 and years following, restoration work was carried on by the Anderson House Foundation, Inc. Missouri State Park Board became owner in 1959 and has continued restoration. House was recorded in an Historic American Buildings Survey project by Kansas City Architect, Kenneth E. Coombs in 1965.

Trenches used by the Union forces during the Battle of Lexington are in evidence on a hilltop adjoining the house site. Battlefield site and slightly rounded trenches are landscaped and maintained as a park by the Missouri State Park Board. Battlefield has not been restored.

Form 10-301  
(Dec. 1968)

UNITED STATES DEPARTMENT OF THE INTERIOR  
NATIONAL PARK SERVICE

**NATIONAL REGISTER OF HISTORIC PLACES  
PROPERTY MAP FORM**

(Type all entries - attach to or enclose with map)

|                  |           |
|------------------|-----------|
| STATE            | Missouri  |
| COUNTY           | Lafayette |
| FOR NPS USE ONLY |           |
| ENTRY NUMBER     | DATE      |

**1. NAME**

COMMON: Anderson House and Lexington Battlefield  
AND/OR HISTORIC: Colonel Oliver Anderson House

**2. LOCATION**

STREET AND NUMBER:  
Sections 27 and 28, Township 51N, Range 27N  
CITY OR TOWN:  
Lexington

**STATE:**

Missouri 61067

**COUNTY:**

Lafayette

**CODE**

24

**CODE**

107

**3. MAP REFERENCE**

SOURCE: Based on Missouri State Park Board Property Map of Anderson House and Lexington Battlefield

SCALE: Approximate scale

DATE: March 1969

**4. REQUIREMENTS**

TO BE INCLUDED ON ALL MAPS

1. Property boundaries where required.
2. North arrow.
3. Latitude and longitude reference.

Lined area indicates property of the State of Missouri and the historic district.

SEE INSTRUCTIONS



NATIONAL REGISTER OF HISTORIC PLACES  
INVENTORY - NOMINATION FORM

(Continuation Sheet)

|                  |      |
|------------------|------|
| STATE            |      |
| Missouri         |      |
| COUNTY           |      |
| Lafayette        |      |
| FOR NPS USE ONLY |      |
| ENTRY NUMBER     | DATE |
|                  |      |

(Number all entries)

ANDERSON HOUSE and  
LEXINGTON BATTLEFIELD

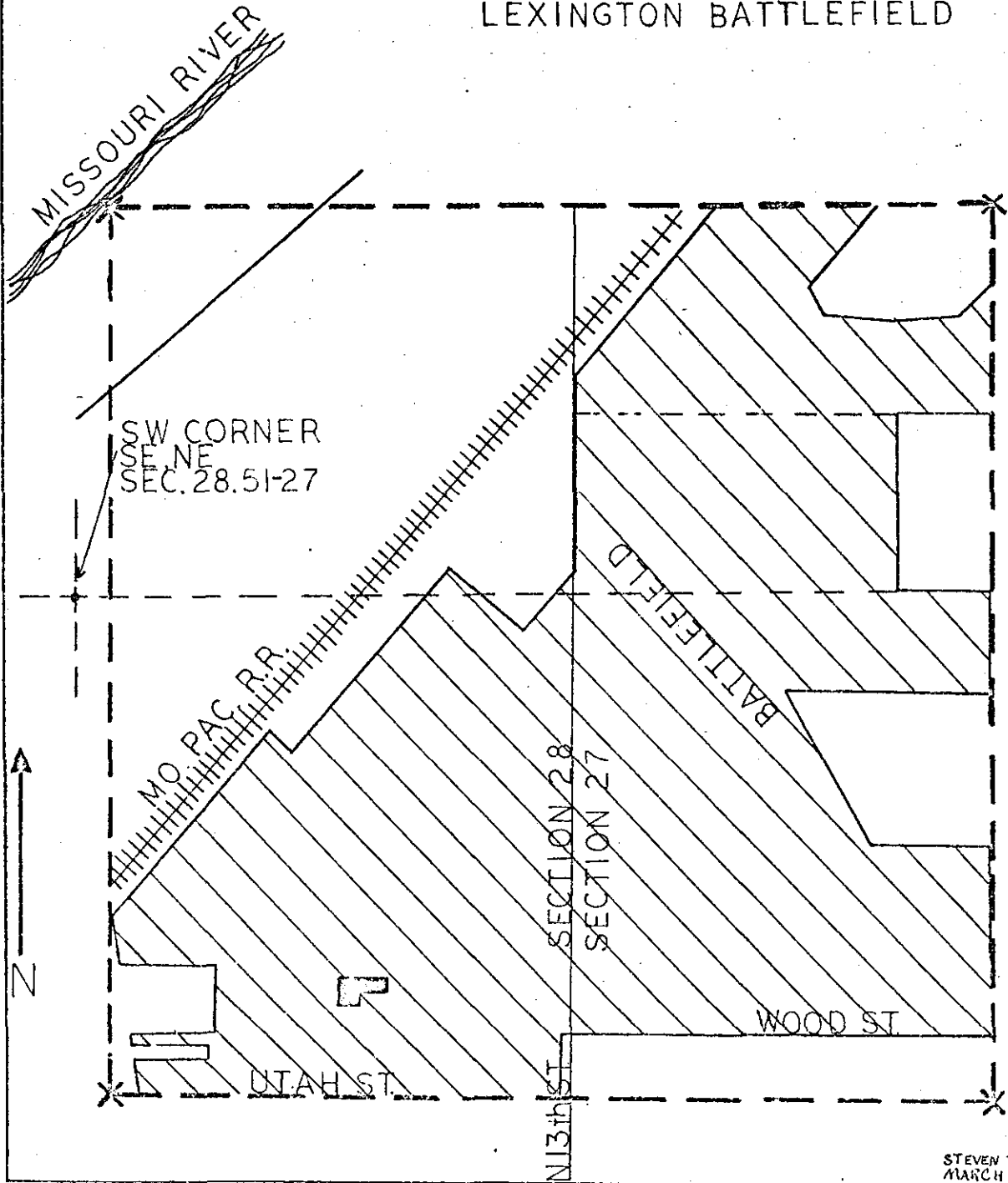

STEVEN TELZAR  
MARCH 25, 1969

Form 10-301  
(Dec. 1968)

UNITED STATES DEPARTMENT OF THE INTERIOR  
NATIONAL PARK SERVICE

**NATIONAL REGISTER OF HISTORIC PLACES  
PROPERTY MAP FORM**

(Type all entries - attach to or enclose with map)

|                  |           |
|------------------|-----------|
| STATE            | Missouri  |
| COUNTY           | Lafayette |
| FOR NPS USE ONLY |           |
| ENTRY NUMBER     | DATE      |

**1. NAME**

COMMON: Anderson House and Lexington Battlefield  
AND/OR HISTORIC: Colonel Oliver Anderson House

**2. LOCATION**

STREET AND NUMBER:  
Sections 27 and 28, Township 51N, Range 27W

CITY OR TOWN:  
Lexington

**STATE:**

Missouri 61057

**COUNTY:**

Lafayette

**CODE**

107

**3. MAP REFERENCE**

**SOURCE:**

U.S.G.S. 7.5 quadrangle Lexington West

SCALE: 1:24,000

DATE: 1950

**4. REQUIREMENTS**

TO BE INCLUDED ON ALL MAPS

1. Property boundaries where required.
2. North arrow.
3. Latitude and longitude reference.

SEE INSTRUCTIONS

Sheet No. 45109, Mylaxia Made of 200 Feet "MYLAXIA" V.P.D. Sheet Protector M/24 Made of 200 Feet "MYLAXIA" V.P.D. A.P.C.

NE 39° 11' 11" 93° 52' 30"  
 SE 39° 11' 25" 93° 52' 30"  
 NW 39° 11' 48" 93° 52' 37"  
 SW 39° 11' 25" 93° 52' 50"

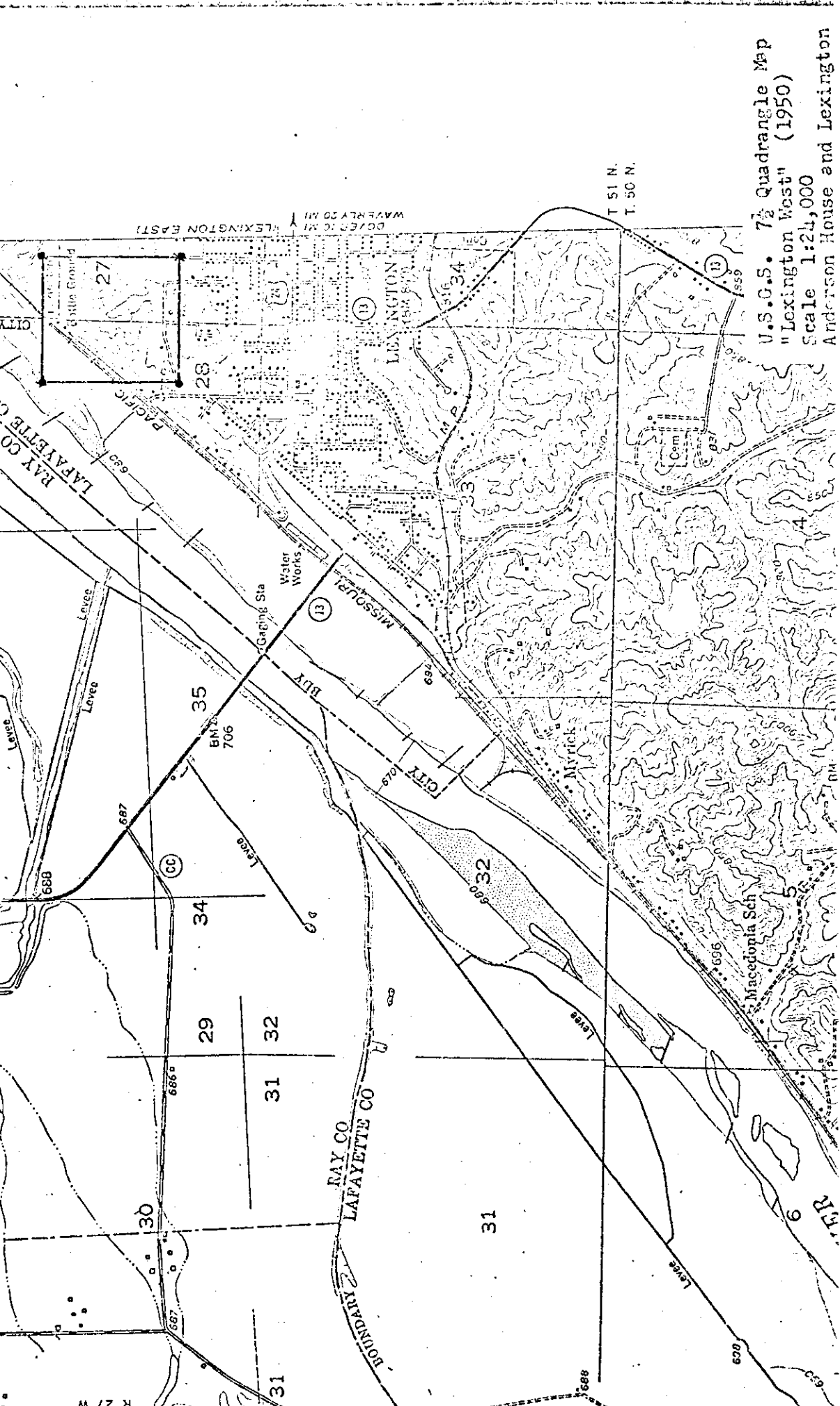

U.S.G.S. 7 1/2 Quadrangle Map  
 "Lexington West" (1950)  
 Scale 1:24,000  
 Anderson House and Lexington

T 51 N.  
T. 50 N.

16 31

17 31

18 31

19 31

20 31

21 31

22 31

23 31

24 31

25 31

26 31

27 31

28 31

29 31

30 31

31 31

32 31

33 31

34 31

35 31

36 31

37 31

38 31

39 31

40 31

41 31

42 31

43 31

44 31

45 31

46 31

47 31

48 31

49 31

50 31

51 31

52 31

53 31

54 31

55 31

56 31

57 31

58 31

59 31

60 31

61 31

62 31

63 31

64 31

65 31

66 31

67 31

68 31

69 31

70 31

71 31

72 31

73 31

74 31

75 31

76 31

77 31

78 31

79 31

80 31

81 31

82 31

83 31

84 31

85 31

86 31

87 31

88 31

89 31

90 31

91 31

92 31

93 31

94 31

95 31

96 31

97 31

98 31

99 31

100 31

ANDERSON HOUSE AND LEXINGTON BATTLEFIELD

|  |   |
|--|---|
| COUNTY:                                      | Lafayette   |
| LOCATION:                                    | Lexington, Mo.  |
| OWNER:                                       | Missouri State Park Board   |
| ADDRESS:                                     | P.O. Box 176, 1204 Jefferson Building,<br>Jefferson City, Mo. 65101 |
| DATE APPROVED BY A.C.:                       | 10-26-68  |
| DATE SENT TO JEFF. CITY:                     |   |
| DATE SENT TO D.C.:                           | 04-11-69  |
| DATE OF REC. IN D.C.:                        | 04-14-69  |
| DATE PLACED ON NATIONAL REGISTER:            | 06-04-69  |
| DATE CERTIFICATE AWARDED<br>(AND PRESENTOR): | 12-28-72  |
| DATE FILE REVIEWED:                          |   |

During the Battle of Lexington this house was used as a hospital by the Union forces under Colonel James Mulligan. It changed hands three times during the battle.

NATIONAL REGISTER OF HISTORIC PLACES  
PROPERTY MAP FORM

(Type all entries - attach to or enclose with map)

|                     |      |
|---------------------|------|
| STATE<br>Missouri   |      |
| COUNTY<br>Lafayette |      |
| FOR NPS USE ONLY    |      |
| ENTRY NUMBER        | DATE |
|                     |      |

SEE INSTRUCTIONS

|   |      |         |      |
|---|------|---------|------|
| <b>1. NAME</b>  |      |         |      |
| COMMON:   |      |         |      |
| AND/OR HISTORIC:  |      |         |      |
| <b>2. LOCATION</b>  |      |         |      |
| STREET AND NUMBER:  |      |         |      |
| CITY OR TOWN:   |      |         |      |
| STATE:  | CODE | COUNTY: | CODE |
|   |      |         |      |
| <b>3. MAP REFERENCE</b>   |      |         |      |
| SOURCE:   |      |         |      |
| SCALE:  |      |         |      |
| DATE:   |      |         |      |
| <b>4. REQUIREMENTS</b>  |      |         |      |
| TO BE INCLUDED ON ALL MAPS  |      |         |      |
| <ol style="list-style-type: none"> <li>1. Property boundaries where required.</li> <li>2. North arrow.</li> <li>3. Latitude and longitude reference.</li> </ol> |      |         |      |

NATIONAL REGISTER OF HISTORIC PLACES  
PROPERTY PHOTOGRAPH FORM

(Type all entries - attach to or enclose with photograph)

|                     |      |
|---------------------|------|
| STATE<br>Missouri   |      |
| COUNTY<br>Lafayette |      |
| FOR NPS USE ONLY    |      |
| ENTRY NUMBER        | DATE |
|                     |      |

SEE INSTRUCTIONS

|   |            |                      |             |
|---|------------|----------------------|-------------|
| <b>1. NAME</b>  |            |                      |             |
| COMMON: Anderson House and Lexington Battlefield  |            |                      |             |
| AND/OR HISTORIC: Colonel Oliver Anderson House  |            |                      |             |
| <b>2. LOCATION</b>  |            |                      |             |
| STREET AND NUMBER:<br>Sections 27 and 28, Township 51N, Range 27W   |            |                      |             |
| CITY OR TOWN:<br>Lexington  |            |                      |             |
| STATE:<br>Missouri 64067  | CODE<br>24 | COUNTY:<br>Lafayette | CODE<br>107 |
| <b>3. PHOTO REFERENCE</b>   |            |                      |             |
| PHOTO CREDIT: Hadley Irwin - Missouri State Park Board  |            |                      |             |
| DATE OF PHOTO: ca. 1950   |            |                      |             |
| NEGATIVE FILED AT: Missouri State Park Board, P.O. Box 176<br>1204 Jefferson Building, Jefferson City, Missouri 65101   |            |                      |             |
| <b>4. IDENTIFICATION</b>  |            |                      |             |
| DESCRIBE VIEW, DIRECTION, ETC.<br>Looking northeast, view of the southwest facade and south gable wall. Well is to right of the house. Back porch is barely visible on the rear of building (east). |            |                      |             |

UNITED STATES DEPARTMENT OF THE INTERIOR  
NATIONAL PARK SERVICE

NATIONAL REGISTER OF HISTORIC PLACES  
PROPERTY PHOTOGRAPH FORM

(Type all entries - attach to or enclose with photograph)

|                                |        |   |      |
|--------------------------------|--------|---|------|
| STATE                          |        | Missouri  |      |
| COUNTY                         |        | Lafayette   |      |
| FOR NPS USE ONLY               |        | ENTRY NUMBER  | DATE |
| 1. NAME                        |        |   |      |
| COMMON:                        |        | Anderson House and Lexington Battlefield  |      |
| AND/OR HISTORIC:               |        | Colonel Oliver Anderson House   |      |
| 2. LOCATION                    |        |   |      |
| STREET AND NUMBER:             |        | Sections 27 and 28, Township 51N, Range 27W   |      |
| CITY OR TOWN:                  |        | Lexington   |      |
| STATE:                         | CODE   | COUNTY:   | CODE |
| Missouri                       | 64-067 | Lafayette   | 707  |
| 3. PHOTO REFERENCE             |        |   |      |
| PHOTO CREDIT:                  |        | Hadley Irwin - Missouri State Park Board  |      |
| DATE OF PHOTO:                 |        | ca. 1950  |      |
| NEGATIVE FILED AT:             |        | Missouri State Park Board, P.O. Box 176<br>1201 Jefferson Building, Jefferson City, Missouri 65107                            |      |
| 4. IDENTIFICATION              |        |   |      |
| DESCRIBE VIEW, DIRECTION, ETC. |        | Looking southeast, view of northwest corner of Anderson House. North gable wall at left with "I" continuation to rear (east). |      |

S E E I N S T R U C T I O N S

UNITED STATES DEPARTMENT OF THE INTERIOR  
NATIONAL PARK SERVICE

NATIONAL REGISTER OF HISTORIC PLACES  
PROPERTY PHOTOGRAPH FORM

(Type all entries - attach to or enclose with photograph)

|                  |           |
|------------------|-----------|
| STATE            | Missouri  |
| COUNTY           | Lafayette |
| FOR NPS USE ONLY |           |
| ENTRY NUMBER     | DATE      |

1. NAME

COMMON: Anderson House and Lexington Battlefield  
AND/OR HISTORIC: Colonel Oliver Anderson House

2. LOCATION

STREET AND NUMBER:  
Sections 27 and 28, Township 51N, Range 27W  
CITY OR TOWN:  
Lexington

STATE:

Missouri 64067

COUNTY:

Lafayette

CODE

24

CODE

107

3. PHOTO REFERENCE

PHOTO CREDIT: M. Patricia Holmes - State Historical Survey  
DATE OF PHOTO: October 31, 1968 1 p.m.  
NEGATIVE FILED AT: Missouri State Park Board, P.O. Box 176  
1204 Jefferson Building, Jefferson City, Missouri 65101

4. IDENTIFICATION

DESCRIBE VIEW, DIRECTION, ETC.

Detail of column capitol (facade northwest corner of porch)  
east iron. Locking east.

S F E I N S T R U C T I O N S



UNITED STATES DEPARTMENT OF THE INTERIOR  
NATIONAL PARK SERVICE

**NATIONAL REGISTER OF HISTORIC PLACES  
PROPERTY PHOTOGRAPH FORM**

*(Type all entries - attach to or enclose with photograph)*

|  |                  |           |
|--|------------------|-----------|
|  | STATE            | Missouri  |
|  | COUNTY           | Lafayette |
|  | FOR NPS USE ONLY |           |
|  | ENTRY NUMBER     |           |
|  | DATE             |           |

**1. NAME**

COMMON: Anderson House and Lexington Battlefield  
AND/OR HISTORIC: Colonel Oliver Anderson House

**2. LOCATION**

STREET AND NUMBER: Sections 27 and 28, Township 51N, Range 27W  
CITY OR TOWN: Lexington

STATE: Missouri 61067      CODE      COUNTY: Lafayette      CODE  
107

**3. PHOTO REFERENCE**

PHOTO CREDIT: M. Patricia Holmes - State Historical Survey  
DATE OF PHOTO: October 31, 1968 7 p.m.  
NEGATIVE FILED AT: Missouri State Park Board, P.O. Box 176  
1201 Jefferson Building, Jefferson City, Missouri 65107

**4. IDENTIFICATION**

DESCRIBE VIEW, DIRECTION, ETC.  
Detail of the cast iron window caps found on every window  
of building. View of the southern-most window on the west  
facade, first floor.

SEE INSTRUCTIONS

All

Photo

Missing