

HAARSTICK - WHITTEMORE HOUSES:
LISTED ON THE NATIONAL REGISTER
OF HISTORIC PLACES

- GEORGIAN/COLONIAL/NEOCLASSICAL
- TUDOR/COTSWOLD/GOTHIC REVIVAL
- SPANISH/MISSION
- ITALIAN/RENAISSANCE
- FRENCH ECLECTIC/CHATEAUESQUE
- MINIMAL PERIOD REVIVAL & CRAFTSMAN
- INTRUSIONS (AFTER 1939)
- BYZANTINE

WYDOWN/FORSYTH
CLAYTON, MISSOURI

0' 100' 200'

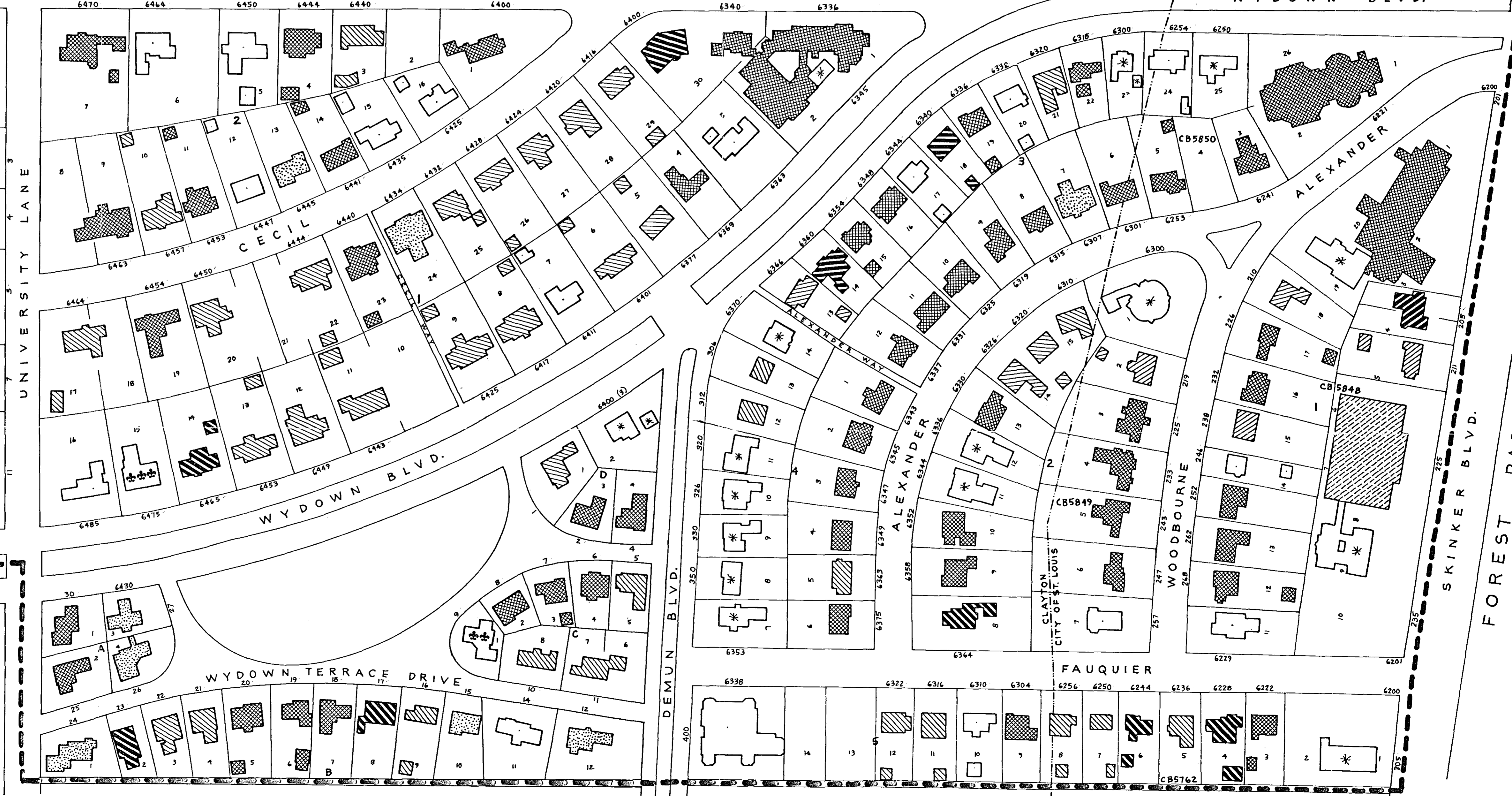

UNIVERSITY LANE

CECIL

WYDOWN BLVD.

WYDOWN TERRACE DRIVE

DEMUN BLVD.

ALEXANDER

WOODBOURNE

SKINKER BLVD.

FOREST PARK

CLAYTON
CITY OF ST. LOUIS

FAUQUIER

SKINKER BLVD.