

# ARCHITECTURAL SURVEY OF FOUNTAIN PARK

APRIL 1979 ST. LOUIS, MISSOURI

LANDMARKS ASSOCIATION OF ST. LOUIS, INC.  
FOR THE COMMUNITY DEVELOPMENT AGENCY

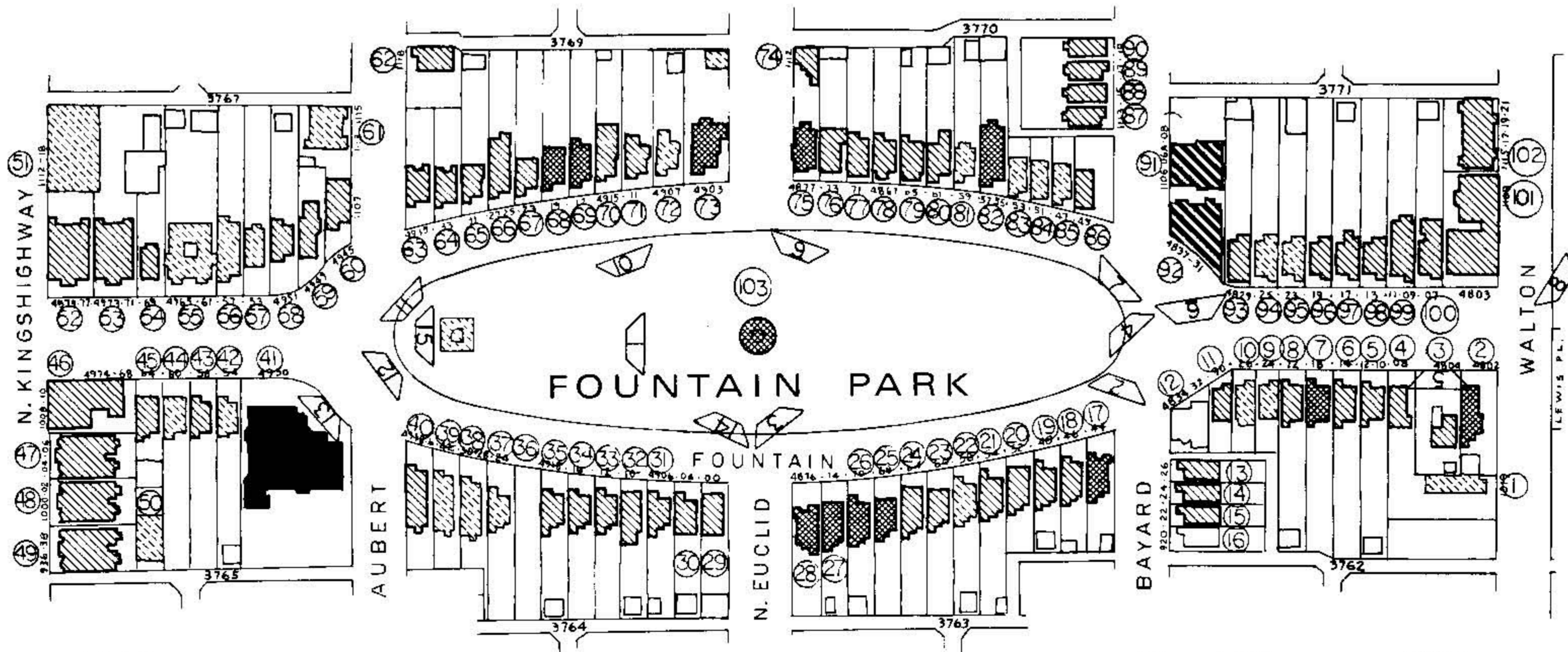

## LEGEND

- NATIONAL SIGNIFICANCE
  - ▨ STATE SIGNIFICANCE
  - ▩ CITY SIGNIFICANCE
  - ▧ NEIGHBORHOOD SIGNIFICANCE
  - ▦ ARCHITECTURAL MERIT -  
DEMOLITION WOULD DIMINISH THE INTEGRITY  
OF THE NEIGHBORHOOD
  - LITTLE OR NO ARCHITECTURAL MERIT -  
DEMOLITION WOULD BE INCONSEQUENTIAL  
OR ADVANTAGEOUS
  - OWNER OF RECORD
  - ◁ PHOTO NO. & CAMERA ANGLE
- } DEMOLITION WOULD BE  
A MAJOR CULTURAL LOSS



## SURVEY:

CAROLYN HEWES TOFT  
WILLIAM P. WISCHMEYER

## REVIEW:

GERHARDT KRAMER  
CARL D. PETTIT III  
W DAVIS VAN BAKERGEM

## MAP:

PAT HAYS BAER

PREPARATION OF THIS MAP WAS FINANCED WHOLLY  
THROUGH A GRANT FROM THE DEPARTMENT OF  
HOUSING AND URBAN DEVELOPMENT AND THE  
COMMUNITY DEVELOPMENT AGENCY OF ST. LOUIS UNDER  
THE PROVISIONS OF TITLE I OF THE HOUSING AND  
COMMUNITY DEVELOPMENT ACT OF 1977 (AS AMENDED).