



## PUBLIC NOTICE

### DRAFT MISSOURI STATE OPERATING PERMIT

DATE: July 7, 2017

In accordance with the state Clean Water Law, Chapter 644, RSMo, Missouri Clean Water Commission regulation 10 CSR 20-6.010, and the Federal Clean Water Act, the applicants listed herein have applied for authorization to either discharge to waters of the state, or to operate a no-discharge wastewater treatment facility. The proposed permits for these operations are consistent with applicable water quality standards, effluent standards and/or treatment requirements or suitable timetables to meet these requirements (see 10 CSR 20-7.015 and 7.031). All permits will be issued for a period of five years unless noted otherwise in the Public Notice for that discharge.

On the basis of preliminary staff review and the application of applicable standards and regulations, the Missouri Department of Natural Resources, as administrative agent for the Missouri Clean Water Commission, proposes to issue a permit(s) subject to certain effluent limitations, schedules, and special conditions. The proposed determinations are tentative pending public comment.

Persons wishing to comment on the proposed permit conditions are invited to submit them in writing to: Missouri Department of Natural Resources, Water Protection Program, P.O. Box 176, Jefferson City, Missouri 65102, ATTN: NPDES Operating Permits /Permit Comments. **Please include the permit number in all comment letters.**

Comments should be confined to the issues relating to the proposed action and permit(s) and the effect on water quality. The department may not consider as relevant comments or objections to a permit based on issues outside the authority of the Missouri Clean Water Commission, (see Curdt v. Mo. Clean Water Commission, 586 S.W.2d 58 Mo. App. 1979).

All comments must be received or postmarked by 5:00 p.m. on August 7, 2017. The department will consider all written comments, including e-mails, faxes and letters, in the formulation of all final determinations regarding the applications. E-mail comments will be accepted at the following address: [publicnoticenpdes@dnr.mo.gov](mailto:publicnoticenpdes@dnr.mo.gov). If response to this notice indicates significant public interest, a public meeting or hearing may be held after due notice for the purpose of receiving public comment on the proposed permit or determination. Public hearings and/or issuance of the permit will be conducted or processed according to 10 CSR 20-6.020.

Copies of all draft permits and other information including copies of applicable regulations are available for inspection and copying at the department's Website: <http://www.dnr.mo.gov/env/wpp/permits/permit-pn.htm>, or at the Missouri Department of Natural Resources, Water Protection Program, P.O. Box 176, Jefferson City, Missouri 65102, between the hours of 8:00 a.m. and 5:00 p.m., Monday through Friday.

STATE OF MISSOURI  
DEPARTMENT OF NATURAL RESOURCES  
MISSOURI CLEAN WATER COMMISSION



## MISSOURI STATE OPERATING PERMIT

In compliance with the Missouri Clean Water Law, (Chapter 644 R.S. Mo. as amended, hereinafter, the Law), and the Federal Water Pollution Control Act (Public Law 92-500, 92<sup>nd</sup> Congress) as amended,

Permit No. MO-0115215

Owner: Panhandle Eastern Pipe Line Company  
Address: 7500 College Blvd., Suite 300, Overland Park, KS 66210

Continuing Authority: Same as above  
Address: Same as above

Facility Name: Panhandle Eastern Pipe Line Company, Centralia Compressor Station  
Facility Address: 16151 North Route Z, Centralia, MO 65240

Legal Description: NE $\frac{1}{4}$ , NW $\frac{1}{4}$ , Sec. 10, T50N, R11W, Boone County  
UTM Coordinates: X= 574425, Y= 4332336

Receiving Stream: Tributary to Silver Fork  
First Classified Stream and ID: 8-20-13 MUDD V1.0 (C) (3960); locally known as Silver Fork  
USGS Basin & Sub-watershed No.: Headwaters Silver Creek (10300102-0703)

is authorized to discharge from the facility described herein, in accordance with the effluent limitations and monitoring requirements as set forth herein:

### FACILITY DESCRIPTION

Panhandle Eastern Pipe Line Company is a natural gas transmission company. Natural gas is transported via underground pipelines for heating and electrical generation purposes. Compressor stations function to compress the gas for further transport in the pipelines.

#### OUTFALL #001 –Wastewater; SIC # 4922

Receives treated wastewater from groundwater/stormwater infiltration into building basements, housekeeping washwater, water softener regeneration water, cooling water, and air compressor condensate. Treatment consists of oil/water separation, particle filtration, and filtration through clay/coal and activated carbon filters.

Design Flow: 0.0095 MGD Average Flow: 0.0042 MGD

OUTFALL #002 –Removed from this permit, discharge is not authorized through this outfall.

This permit authorizes only wastewater discharges under the Missouri Clean Water Law and the National Pollutant Discharge Elimination System; it does not apply to other regulated areas. This permit may be appealed in accordance with Sections 640.013, 621.250, and 644.051.6 of the Law.

Effective Date

Edward B. Galbraith, Director, Division of Environmental Quality

Expiration Date

David J Lamb, Acting Director, Water Protection Program

**A. EFFLUENT LIMITATIONS AND MONITORING REQUIREMENTS**

EFFLUENT PARAMETERS	UNITS	FINAL EFFLUENT LIMITATIONS			MONITORING REQUIREMENTS	
		DAILY MAXIMUM	WEEKLY AVERAGE	MONTHLY AVERAGE	MEASUREMENT FREQUENCY	SAMPLE TYPE
<b>PHYSICAL</b>						
Flow	MGD	*		*	once/quarter	24 hr. total
<b>CONVENTIONAL</b>						
Chemical Oxygen Demand	mg/L	90		60	once/quarter	grab
Oil & Grease	mg/L	15		10	once/quarter	grab
pH Ω	SU	6.5 to 9.0		6.5 to 9.0	once/quarter	grab
Total Suspended Solids	mg/L	45		30	once/quarter	grab
<b>METALS</b>						
Iron, Total Recoverable	µg/L	1850		682	once/quarter	grab
<b>OTHER</b>						
Chloride	mg/L	359		195	once/quarter	grab

MONITORING REPORTS SHALL BE SUBMITTED QUARTERLY; THE FIRST REPORT IS DUE **MONTH 28, 20XX**.  
THERE SHALL BE NO DISCHARGE OF FLOATING SOLIDS OR VISIBLE FOAM IN OTHER THAN TRACE AMOUNTS.

\* Monitoring requirement only.

Ω The facility will report the minimum and maximum values. pH is not to be averaged.

◇ Quarterly sampling

MINIMUM QUARTERLY SAMPLING REQUIREMENTS			
QUARTER	MONTHS	QUARTERLY EFFLUENT PARAMETERS	REPORT IS DUE
First	January, February, March	Sample at least once during any month of the quarter	April 28 <sup>th</sup>
Second	April, May, June	Sample at least once during any month of the quarter	July 28 <sup>th</sup>
Third	July, August, September	Sample at least once during any month of the quarter	October 28 <sup>th</sup>
Fourth	October, November, December	Sample at least once during any month of the quarter	January 28 <sup>th</sup>

**B. STANDARD CONDITIONS**

In addition to specified conditions stated herein, this permit is subject to the attached Part I standard conditions dated August 1, 2014 and hereby incorporated as though fully set forth herein.

**C. SPECIAL CONDITIONS**

1. Electronic Discharge Monitoring Report (eDMR) Submission System
  - (a) The permittee shall submit an eDMR Permit Holder and Certifier Registration form within **90 days** of the effective date of this permit. Per 40 CFR Part 127 National Pollutant Discharge Elimination System (NPDES) Electronic Reporting Rule, reporting of effluent limits and monitoring shall be submitted by the permittee via an electronic system to ensure a timely, complete, accurate, and nationally-consistent set of data. Visit <http://dnr.mo.gov/pubs/pub2474.pdf> to access the Facility Participation Package which contains the eDMR Permit Holder and Certifier Registration form. Once the permittee is activated in the eDMR system:

C. SPECIAL CONDITIONS (CONTINUED)

- (b) Programmatic Reporting Requirements. The following reports (if required by this permit) must be electronically submitted as an attachment to the eDMR system until such a time when the current or a new system is available to allow direct input of the data:
- (1) Any additional report required by the permit excluding bypass reporting.  
After such a system has been made available by the department, required data shall be directly input into the system by the next report due date.
- (c) Other actions. The following shall be submitted electronically after such a system has been made available by the department:
- (1) General Permit Applications/Notices of Intent to discharge (NOIs);
  - (2) Notices of Termination (NOTs);
  - (3) No Exposure Certifications (NOEs);
  - (4) Low Erosivity Waivers and Other Waivers from Stormwater Controls (LEWs); and
  - (5) Bypass reporting.
- (d) Electronic Submissions. To access the eDMR system, use the following link in your web browser: <https://edmr.dnr.mo.gov/edmr/E2/Shared/Pages/Main/Login.aspx>.
- (e) Waivers from Electronic Reporting. The permittee must electronically submit compliance monitoring data and reports unless a waiver is granted by the department in compliance with 40 CFR Part 127. The permittee may obtain an electronic reporting waiver by first submitting an eDMR Waiver Request Form: <http://dnr.mo.gov/forms/780-2692-f.pdf>. The department will either approve or deny this electronic reporting waiver request within 120 calendar days. Only permittees with an approved waiver request may submit monitoring data and reports on paper to the Department for the period that the approved electronic reporting waiver is effective.
2. To protect the general criteria found at 10 CSR 20-7.031(4), before releasing water accumulated in secondary containment areas, it must be examined for hydrocarbon odor and presence of sheen. If the presence of odor or sheen is indicated, the water shall be treated using an appropriate method or disposed of in accordance with legally approved methods, such as being sent to a wastewater treatment facility. Following treatment, the water shall be tested for oil and grease, benzene, toluene, ethylbenzene, and xylene using 40 CFR part 136 methods. All pollutant levels must be below the most protective, applicable standards for the receiving stream, found in 10 CSR 20-7.031 Table A. Records of all testing and treatment of water accumulated in secondary containment shall be stored in the SWPPP to be available on demand to DNR and EPA personnel.
3. The full implementation of this operating permit, which includes implementation of any applicable schedules of compliance, shall constitute compliance with all applicable federal and state statutes and regulations in accordance with §644.051.16, RSMo, and the CWA section 402(k); however, this permit may be reopened and modified, or alternatively revoked and reissued to comply with any applicable effluent standard or limitation issued or approved under Sections 301(b)(2)(C) and (D), §304(b)(2), and §307(a) (2) of the Clean Water Act, if the effluent standard or limitation so issued or approved contains different conditions or is otherwise more stringent than any effluent limitation in the permit; or controls any pollutant not limited in the permit.
4. All outfalls must be clearly marked in the field.
5. Changes in Discharges of Toxic Pollutant  
In addition to the reporting requirements under §122.41(1), all existing manufacturing, commercial, mining, and silvicultural dischargers must notify the Director as soon as they know or have reason to believe:
- (a) That an activity has occurred or will occur which would result in the discharge, on a routine or frequent basis, of any toxic pollutant which is not limited in the permit, if that discharge will exceed the highest of the following notification levels:
    - (1) One hundred micrograms per liter (100 µg/L);
    - (2) Two hundred micrograms per liter (200 µg/L) for acrolein and acrylonitrile;
    - (3) Five hundred micrograms per liter (500 µg/L) for 2,4-dinitrophenol and for 2-methyl-4, 6-dinitrophenol;
    - (4) One milligram per liter (1 mg/L) for antimony;
    - (5) Five (5) times the maximum concentration value reported for the pollutant in the permit application in accordance with 40 CFR 122.21(g)(7); or
    - (6) The notification level established by the department in accordance with 40 CFR 122.44(f).
  - (b) That any activity has occurred or will occur which would result in any discharge, on a non-routine or infrequent basis, of a toxic pollutant which is not limited in the permit, if that discharge will exceed the highest of the following "notification levels":
    - (1) Five hundred micrograms per liter (500 µg/l);
    - (2) One milligram per liter (1 mg/l) for antimony;

C. SPECIAL CONDITIONS (CONTINUED)

- (3) Ten (10) times the maximum concentration value reported for that pollutant in the permit application in accordance with §122.21(g)(7).
  - (4) The level established by the Director in accordance with §122.44(f).
6. Report as no-discharge when a discharge does not occur during the report period.
7. Reporting of Non-Detects
  - (a) An analysis conducted by the permittee or their contracted laboratory shall be conducted in such a way that the precision and accuracy of the analyzed result can be enumerated.
  - (b) The permittee shall not report a sample result as “non-detect” without also reporting the detection limit of the test. Reporting as “non-detect” without also including the detection limit will be considered failure to report, which is a violation of this permit.
  - (c) The permittee shall report the “non-detect” result using the less than sign and the minimum detection limit (e.g. <10).
  - (d) Where the permit contains a Minimum Level (ML) and the permittee is granted authority in the permit to report zero in lieu of the < ML for a specified parameter (conventional, priority pollutants, metals, etc.), then zero (0) is to be reported for that parameter.
  - (e) See Standard Conditions Part I, Section A, #4 regarding proper detection limits used for sample analysis.
  - (f) When calculating monthly averages, one-half of the minimum detection limit (MDL) should be used instead of a zero. Where all data are below the MDL, the “<MDL” shall be reported as indicated in item (C).
8. It is a violation of the Missouri Clean Water Law to fail to pay fees associated with this permit (644.055 RSMo).

**MISSOURI DEPARTMENT OF NATURAL RESOURCES  
FACT SHEET  
FOR THE PURPOSE OF RENEWAL  
OF  
MO-0115215  
PANHANDLE EASTERN PIPELINE COMPANY-CENTRALIA STATION**

The Federal Water Pollution Control Act ("Clean Water Act" Section 402 Public Law 92-500 as amended) established the National Pollution Discharge Elimination System (NPDES) permit program. This program regulates the discharge of pollutants from point sources into the waters of the United States, and the release of stormwater from certain point sources. All such discharges are unlawful without a permit (Section 301 of the "Clean Water Act"). After a permit is obtained, a discharge not in compliance with all permit terms and conditions is unlawful. Missouri State Operating Permits (MSOPs) are issued by the Director of the Missouri Department of Natural Resources (Department) under an approved program, operating in accordance with federal and state laws (Federal "Clean Water Act" and "Missouri Clean Water Law" Section 644 as amended). MSOPs are issued for a period of five (5) years unless otherwise specified for less.

As per [40 CFR Part 124.8(a)] and [10 CSR 20-6.020(1)2.] a factsheet shall be prepared to give pertinent information regarding the applicable regulations, rationale for the development of effluent limitations and conditions, and the public participation process for the Missouri State Operating Permit (MSOP or operating permit) listed below. A factsheet is not an enforceable part of an operating permit.

**Part I. FACILITY INFORMATION**

Facility Type: Industrial  
 Facility SIC Code(s): 4922  
 Facility NAICS Code: 486210  
 Application Date: 09/08/2015  
 Expiration Date: 03/31/2016  
 Last Inspection: 10/07/2014; not in compliance at the time of inspection

**FACILITY DESCRIPTION:**

Panhandle Eastern Pipe Line Company is a natural gas transmission company. Natural gas is transported via underground pipelines for heating and electrical generation purposes. Compressor stations function to compress the gas for further transport in the pipelines.

**OUTFALL #001** –Wastewater; SIC # 4922

Receives treated wastewater from groundwater/stormwater infiltration into building basements, housekeeping washwater, water softener regeneration water, cooling water, and air compressor condensate. Treatment consists of oil/water separation, particle filtration, and filtration through clay/coal and activated carbon filters.

**OUTFALL #002** –Removed from this permit, discharge is not authorized through this outfall. This outfall is removed as the permittee reports this outfall does not discharge, and any build-up of stormwater will be pumped/directed to outfall #001.

**PERMITTED FEATURES TABLE:**

OUTFALL	AVERAGE FLOW (MGD)	DESIGN FLOW (MGD)	TREATMENT LEVEL	EFFLUENT TYPE
#001	0.0095	0.0042	Primary	industrial wastewater
#002	Removed from this permit; discharge is not authorized from this outfall.			

**FACILITY PERFORMANCE HISTORY & COMMENTS:**

The discharge monitoring reports were reviewed for the last five years. Limit exceedances were noted for COD, chloride, and total recoverable iron. The facility was found to be not in compliance during the last WPP inspection. The unsatisfactory features noted were: 1) the facility failed to submit timely DMRs as required in the operating permit; 2) the facility failed to comply with effluent limits in the operating permit. The facility later returned to compliance.

**FACILITY MAP:**



**WATER BALANCE DIAGRAM:**

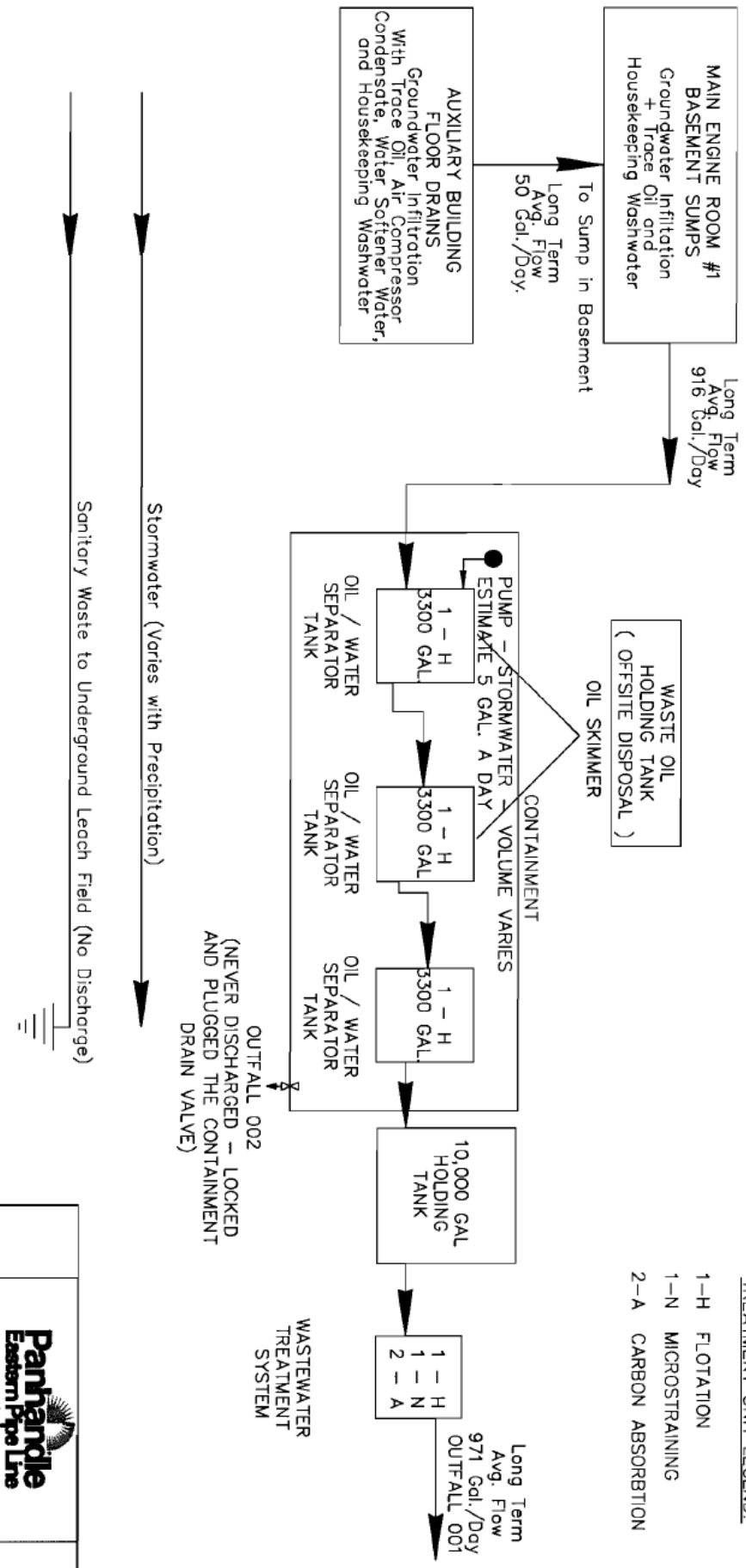

TREATMENT UNIT LEGEND:

- 1-H FLOTATION
- 1-N MICROSTRAINING
- 2-A CARBON ABSORPTION

NOTE: Potable Water Provided by Public Water Supply District #4

**Panhandle Eastern Pipeline**  
 FIGURE 1

**Part II. RECEIVING STREAM INFORMATION**



**RECEIVING WATER BODY'S WATER QUALITY:**

The receiving stream Tributary to Silver Fork has no concurrent water quality data available. No relevant water quality information was found about the first classified receiving stream, 8-20-13 MUDD V1.0 (C)(3960, locally known as Silver Fork.

**303(D) LIST:**

Section 303(d) of the federal Clean Water Act requires each state identify waters not meeting water quality standards and for which adequate water pollution controls have not been required. Water quality standards protect such beneficial uses of water as whole body contact (such as swimming), maintaining fish and other aquatic life, and providing drinking water for people, livestock, and wildlife. The 303(d) list helps state and federal agencies keep track of impaired waters not addressed by normal water pollution control programs. <http://dnr.mo.gov/env/wpp/waterquality/303d/303d.htm>

✓ Not applicable; this facility does not discharge to an impaired segment of a 303(d) listed stream.

**TOTAL MAXIMUM DAILY LOAD (TMDL):**

A TMDL is a calculation of the maximum amount of a given pollutant that a body of water can absorb before its water quality is affected; hence, the purpose of a TMDL is to determine the pollutant loading a specific waterbody can assimilate without exceeding water quality standards. If a water body is determined to be impaired as listed on the 303(d) list, then a watershed management plan or TMDL may be developed. The TMDL shall include the WLA calculation. <http://dnr.mo.gov/env/wpp/tmdl/>

✓ Not applicable; this facility is not associated with a TMDL.

**APPLICABLE DESIGNATIONS OF WATERS OF THE STATE:**

✓ As per Missouri's Effluent Regulations [10 CSR 20-7.015(1)(B)], the waters of the state are divided into the following seven categories. Each category lists effluent limitations for specific parameters, which are presented in each outfall's effluent limitation table and further discussed in the derivation & discussion of limits section.

- Missouri or Mississippi River:
- Lake or Reservoir:
- Losing:
- All Other Waters:

**RECEIVING STREAMS TABLE:**

OUTFALL	WATERBODY NAME	CLASS	WBID	DESIGNATED USES*	DISTANCE TO SEGMENT (MILES)	12-DIGIT HUC
#001	Tributary to Silver Fork	n/a	n/a	GEN	0.78	Headwaters Silver Creek 10300102-0703
	8-20-13 MUDD V1.0 Locally known as Silver Fork	C	3960	HHP, IRR, LWW, SCR, WBC-B, WWH (AQL)		

n/a not applicable

WBID = Waterbody Identification; Missouri Use Designation Dataset 8-20-13 MUDD V1.0 data can be found as an ArcGIS shapefile on MSDIS at [ftp://msdis.missouri.edu/pub/Inland\\_Water\\_Resources/MO\\_2014\\_WQS\\_Stream\\_Classifications\\_and\\_Use\\_shp.zip](ftp://msdis.missouri.edu/pub/Inland_Water_Resources/MO_2014_WQS_Stream_Classifications_and_Use_shp.zip)

\* As per 10 CSR 20-7.031 Missouri Water Quality Standards, the department defines the Clean Water Commission's water quality objectives in terms of "water uses to be maintained and the criteria to protect those uses." The receiving stream and 1<sup>st</sup> classified receiving stream's beneficial water uses to be maintained are in the receiving stream table in accordance with [10 CSR 20-7.031(1)(C)].

Uses which may be found in the receiving streams table, above:

10 CSR 20-7.031(1)(C)1.:

**AQL** = Protection of aquatic life (Current narrative use(s) are defined to ensure the protection and propagation of fish shellfish and wildlife, which is further subcategorized as: WWH = Warm Water Habitat; CLH = Cool Water Habitat; CDH = Cold Water Habitat; EAH = Ephemeral Aquatic Habitat; MAH = Modified Aquatic Habitat; LAH = Limited Aquatic Habitat. This permit uses AQL effluent limitations in 10 CSR 20-7.031 Table A for all habitat designations unless otherwise specified.)

10 CSR 20-7.031(1)(C)2.: Recreation in and on the water

WBC = Whole Body Contact recreation where the entire body is capable of being submerged;

**WBC-A** = Whole body contact recreation supporting swimming uses and has public access;

**WBC-B** = Whole body contact recreation supporting swimming;

**SCR** = Secondary Contact Recreation (like fishing, wading, and boating).

10 CSR 20-7.031(1)(C)3. to 7.:

**HHP** (formerly HHP) = Human Health Protection as it relates to the consumption of fish;

**IRR** = Irrigation for use on crops utilized for human or livestock consumption;

**LWW** = Livestock and wildlife watering (Current narrative use is defined as LWP = Livestock and Wildlife Protection);

**DWS** = Drinking Water Supply;

**IND** = Industrial water supply

10 CSR 20-7.031(1)(C)8-11.: Wetlands (10 CSR 20-7.031 Table A currently does not have corresponding habitat use criteria for these defined uses)

WSA = Storm- and flood-water storage and attenuation; WHP = Habitat for resident and migratory wildlife species;

WRC = Recreational, cultural, educational, scientific, and natural aesthetic values and uses; WHC = Hydrologic cycle maintenance.

10 CSR 20-7.031(6): GRW = Groundwater

**MIXING CONSIDERATIONS:**

Mixing zone: not allowed [10 CSR 20-7.031(5)(A)4.B.(I)(a)].

Zone of initial dilution: not allowed [10 CSR 20-7.031(5)(A)4.B.(I)(b)].

**RECEIVING STREAM MONITORING REQUIREMENTS:**

No receiving water monitoring requirements are recommended at this time.

**Part III. RATIONALE AND DERIVATION OF EFFLUENT LIMITATIONS & PERMIT CONDITIONS**

**ALTERNATIVE EVALUATIONS FOR NEW FACILITIES:**

As per [10 CSR 20-7.015(4)(A)], discharges to losing streams shall be permitted only after other alternatives including land application, discharges to a gaining stream and connection to a regional wastewater treatment facility have been evaluated and determined to be unacceptable for environmental and/or economic reasons.

- ✓ Not applicable; the facility does not discharge to a losing stream as defined by [10 CSR 20-2.010(36)] & [10 CSR 20-7.031(1)(N)].

**ANTI-BACKSLIDING:**

Federal Regulations [CWA §303(d)(4); CWA §402(c); 40 CFR Part 122.44(I)] require a reissued permit to be as stringent as the previous permit with some exceptions. Backsliding (a less stringent permit limitation) is only allowed under certain conditions.

- ✓ Limitations in this operating permit for the reissuance conform to the anti-backsliding provisions of Section 402(o) of the Clean Water Act, and 40 CFR Part 122.44.
- ✓ Information is available which was not available at the time of permit issuance (other than revised regulations, guidance, or test methods) which would have justified the application of a less stringent effluent limitation.
  - Five years of DMR data were available to the permit writer and support elevated effluent limitations on total recoverable iron. These limits are increased due to site specific data being used in the RPA calculator which led to less stringent limits than those previously applied. These limits are protective of water quality in the receiving stream.
- ✓ The Department determined technical mistakes or mistaken interpretations of law were made in issuing the permit under section 402(a)(1)(b).
  - The previous permit contained a specific set of prohibitions related to general criteria found in 10 CSR 20-7.031(4); however, there was no determination as to whether the discharges have reasonable potential to cause or contribute to excursion of those general water quality standards in the previous permit. Federal regulations 40 CFR 122.44(d)(1)(iii) requires that in instances where reasonable potential (RP) to cause or contribute to an exceedance of a water quality standard exists, a numeric limitation must be included in the permit. Rather than conducting the appropriate RP determination and establishing numeric effluent limitations for specific pollutant parameters, the previous permit simply placed the prohibitions in the permit. These conditions were removed from the permit. Appropriate reasonable potential determinations were conducted for each general criterion listed in 10 CSR 20-7.031(4) and effluent limitations were placed in the permit for those general criteria where it was determined the discharge had reasonable potential to cause or contribute to excursions of the general criteria. Specific effluent limitations were not included for those general criteria where it was determined that the discharges will not cause or contribute to excursions of general criteria. Removal of the prohibitions does not reduce the protections of the permit or allow for impairment of the receiving stream. The permit maintains sufficient effluent limitations, monitoring requirements and best management practices to protect water quality
  - Special conditions regarding SWPPP development and stormwater management have been removed from this permit as this facility does not discharge regulated stormwater.
  - The special condition stating: "Oil collected by the oil water separator shall be treated as used oil consistent with the requirements of 10 CSR 25-11.279." has been removed from the permit. NPDES requirements do not extend to enforcing hazardous waste regulations.

**ANTIDEGRADATION REVIEW:**

For process water discharge with new, altered, or expanding discharges, the department is to document, by means of antidegradation review, if the use of a water body's available assimilative capacity is justified. In accordance with Missouri's water quality regulations for antidegradation [10 CSR 20-7.031(3)], degradation may be justified by documenting the socio-economic importance of a discharge after determining the necessity of the discharge. Facilities must submit the antidegradation review request to the department prior to establishing, altering, or expanding discharges. See <http://dnr.mo.gov/env/wpp/permits/antideg-implementation.htm>

- ✓ Not applicable; the facility has not submitted information proposing expanded or altered process water discharge; no further degradation proposed therefore no further review necessary.

For stormwater discharges with new, altered, or expanding discharges, the stormwater BMP chosen for the facility, through the antidegradation analysis performed by the facility, must be implemented and maintained at the facility. Failure to implement and maintain the chosen BMP alternative is a permit violation; see SWPPP.

- ✓ Not applicable; the facility does not have stormwater discharges or the stormwater outfalls onsite have no industrial exposure.

**BENCHMARKS:**

When a permitted feature or outfall consists of only stormwater, a benchmark may be implemented at the discretion of the permit writer. Benchmarks require the facility to monitor, and if necessary, replace and update stormwater control measures. Benchmark concentrations are not effluent limitations. A benchmark exceedance, therefore, is not a permit violation; however, failure to take

corrective action is a violation of the permit. Benchmark monitoring data is used to determine the overall effectiveness of control measures and to assist the permittee in knowing when additional corrective actions may be necessary to comply with the limitations of the permit.

Because of the fleeting nature of stormwater discharges, the department, under the direction of EPA guidance, has determined monthly averages are capricious measures of stormwater discharges. The *Technical Support Document for Water Quality Based Toxics Control* (EPA/505/2-90-001; 1991) Section 3.1 indicates most procedures within the document apply only to water quality based approaches, not end-of-pipe technology-based controls. Hence, stormwater only outfalls will generally only contain a maximum daily limit (MDL), benchmark, or monitoring requirement determined by the site specific conditions including the receiving water's current quality. While inspections of the stormwater BMPs occur monthly, facilities with no compliance issues are usually expected to sample stormwater quarterly.

Numeric benchmark values are based on water quality standards or other stormwater permits including guidance forming the basis of Environmental Protection Agency's (EPA's) *Multi-Sector General Permit for Stormwater Discharges Associated with Industrial Activity* (MSGP). Because precipitation events are sudden and momentary, benchmarks based on state or federal standards or recommendations use the Criteria Maximum Concentration (CMC) value, or acute standard. The CMC is the estimate of the highest concentration of a material in surface water to which an aquatic community can be exposed briefly without resulting in an unacceptable effect. The CMC for aquatic life is intended to be protective of the vast majority of the aquatic communities in the United States.

✓ Not applicable; this facility does not have any stormwater outfalls.

#### **BIOSOLIDS & SEWAGE SLUDGE:**

Biosolids are solid materials resulting from domestic wastewater treatment meeting federal and state criteria for beneficial use (i.e. fertilizer). Sewage sludge is solid, semi-solid, or liquid residue generated during the treatment of domestic sewage in a treatment works; including but not limited to, domestic septage; scum or solids removed in primary, secondary, or advanced wastewater treatment process; and material derived from sewage sludge. Sewage sludge does not include ash generated during the firing of sewage sludge in a sewage sludge incinerator or grit and screening generated during preliminary treatment of domestic sewage in a treatment works. Additional information: <http://extension.missouri.edu/main/DisplayCategory.aspx?C=74> (WQ422 through WQ449).

✓ Not applicable; this condition is not applicable to the permittee for this facility.

#### **COMPLIANCE AND ENFORCEMENT:**

Enforcement is the action taken by the Water Protection Program (WPP) to bring an entity into compliance with the Missouri Clean Water Law, its implementing regulations, and/or any terms and conditions of an operating permit. The primary purpose of the enforcement activity in the WPP is to resolve violations and return the entity to compliance.

✓ Not applicable; the permittee/facility is not currently under Water Protection Program enforcement action.

#### **EFFLUENT LIMITATION GUIDELINE:**

Effluent Limitation Guidelines, or ELGs, are found at 40 CFR 400-499. These are limitations established by the EPA based on the SIC code and the type of work a facility is conducting. Most ELGs are for process wastewater and some address stormwater. All are technology based limitations which must be met by the applicable facility at all times.

✓ The facility does not have an associated ELG.

#### **GROUNDWATER MONITORING:**

Groundwater is a water of the state according to 10 CSR 20-7.015(7) and 10 CSR 20-7.031(6) and must be protected accordingly.

✓ This facility is not required to monitor groundwater for the water protection program.

#### **INDUSTRIAL SLUDGE:**

Industrial sludge is solid, semi-solid, or liquid residue generated during the treatment of industrial process wastewater in a treatment works; including but not limited to, scum or solids removed in primary, secondary, or advanced wastewater treatment process; scum and solids filtered from water supplies and backwashed; and a material derived from industrial sludge.

✓ Not applicable; sludge is not generated at this facility.

#### **REASONABLE POTENTIAL ANALYSIS (RPA):**

Federal regulation [40 CFR Part 122.44(d)(1)(i)] requires effluent limitations for all pollutants that are (or may be) discharged at a level causing or have the reasonable potential to cause (or contribute to) an in-stream excursion above narrative or numeric water quality standards. If the permit writer determines any give pollutant has the reasonable potential to cause or contribute to an in-stream excursion above the WQS, the permit must contain effluent limits for that pollutant [40 CFR Part 122.44(d)(1)(iii)].

✓ Applicable; an RPA was conducted on appropriate parameters and was conducted as per (TSD, EPA/505/2-90-001, Section 3.3.2). A more detailed version including calculations of this RPA is available upon request. See Wasteload Allocations (WLA) for Limits in this section.

Parameter	CMC	RWC Acute	CCC	RWC Chronic	n	Range min; max	CV	MF	RP Yes/No
Metals									
Iron, Total Recoverable (µg/L)	N/A	N/A	1000.0	2947.67	20	50; 831	1.2	3.55	Yes
Other									
Chloride (mg/L)	860.0	269.57	230.0	269.57	19	14.1; 130	0.5	2.07	Yes

N/A Not Applicable  
n number of samples. If the number of samples is 10 or greater, then the CV value must be used in the WQBEL for the applicable constituent.  
CV Coefficient of Variation (CV) is calculated by dividing the Standard Deviation of the sample set by the Mean of the same sample set.  
RWC Receiving Water Concentration: concentration of a toxicant or the parameter in the receiving water after mixing (if applicable).  
MF Multiplying Factor. 99% Confidence Level and 99% Probability Basis.  
RP Reasonable Potential: an effluent is projected or calculated to cause an excursion above a water quality standard based on a number of factors including, as a minimum, the four factors listed in 40 CFR 122.44(d)(1)(ii).

**SCHEDULE OF COMPLIANCE (SOC):**

A schedule of remedial measures included in a permit, including an enforceable sequence of interim requirements (actions, effluent limits, operations, or milestone events) leading to compliance with the Missouri Clean Water Law, its implementing regulations, and/or the terms and conditions of an operating permit. SOCs are allowed under 40 CFR 122.47 providing certain conditions are met.  
✓ Not applicable; this permit does not contain a schedule of compliance.

**SPILL REPORTING:**

Per 10 CSR 24-3.010, any emergency involving a hazardous substance must be reported to the department’s 24 hour Environmental Emergency Response hotline at (573) 634-2436 at the earliest practicable moment after discovery. The department may require the submittal of a written report detailing measures taken to clean up a spill. These reporting requirements apply whether or not the spill results in chemicals or materials leaving the permitted property or reaching waters of the state. This requirement is in addition to the noncompliance reporting requirement found in Standard Conditions Part I. <http://dnr.mo.gov/env/esp/spillbill.htm>

**STORMWATER POLLUTION PREVENTION PLAN (SWPPP):**

In accordance with 40 CFR 122.44(k), Best Management Practices (BMPs) must be used to control or abate the discharge of pollutants when: 1) Authorized under section 304(e) of the Clean Water Act (CWA) for the control of toxic pollutants and hazardous substances from ancillary industrial activities; 2) Authorized under section 402(p) of the CWA for the control of stormwater discharges; 3) Numeric effluent limitations are infeasible; or 4) the practices are reasonably necessary to achieve effluent limitations and standards or to carry out the purposes and intent of the CWA. In accordance with the EPA’s *Developing Your Stormwater Pollution Prevention Plan, A Guide for Industrial Operators*, (Document number EPA 833-B-09-002) [published by the United States Environmental Protection Agency (USEPA) in February 2009], BMPs are measures or practices used to reduce the amount of pollution entering waters of the state from a permitted facility. BMPs may take the form of a process, activity, or physical structure. Additionally in accordance with the Stormwater Management, a SWPPP is a series of steps and activities to 1) identify sources of pollution or contamination, and 2) select and carry out actions which prevent or control the pollution of storm water discharges.

A SWPPP must be prepared by the permittee if the SIC code is found in 40 CFR 122.26(b)(14) and/or 10 CSR 20-6.200(2). A SWPPP may be required of other facilities where stormwater has been identified as necessitating better management. The purpose of a SWPPP is to comply with all applicable stormwater regulations by creating an adaptive management plan to control and mitigate stream pollution from stormwater runoff. Developing a SWPPP provides opportunities to employ appropriate BMPs to minimize the risk of pollutants being discharged during storm events. The following paragraph outlines the general steps the permittee should take to determine which BMPs will work to achieve the benchmark values or limits in the permit. This section is not intended to be all encompassing or restrict the use of any physical BMP or operational and maintenance procedure assisting in pollution control. Additional steps or revisions to the SWPPP may be required to meet the requirements of the permit.

Areas which should be included in the SWPPP are identified in 40 CFR 122.26(b)(14). Once the potential sources of stormwater pollution have been identified, a plan should be formulated to best control the amount of pollutant being released and discharged by each activity or source. This should include, but is not limited to, minimizing exposure to stormwater, good housekeeping measures, proper facility and equipment maintenance, spill prevention and response, vehicle traffic control, and proper materials handling. Once a plan has been developed the facility will employ the control measures determined to be adequate to achieve the benchmark values discussed above. The facility will conduct monitoring and inspections of the BMPs to ensure they are working properly and re-evaluate any BMP not achieving compliance with permitting requirements. For example, if sample results from an outfall show values of TSS above the benchmark value, the BMP being employed is deficient in controlling stormwater pollution. Corrective action should be taken to repair, improve, or replace the failing BMP. This internal evaluation is required at least once per month but should be continued more frequently if BMPs continue to fail. If failures do occur, continue this trial and error process until appropriate BMPs have been established.

For new, altered, or expanded stormwater discharges, the SWPPP shall identify reasonable and effective BMPs while accounting for environmental impacts of varying control methods. The antidegradation analysis must document why no discharge or no exposure

options are not feasible. The selection and documentation of appropriate control measures shall serve as an alternative analysis of technology and fulfill the requirements of antidegradation [10 CSR 20-7.031(3)]. For further guidance, consult the antidegradation implementation procedure (<http://dnr.mo.gov/env/wpp/docs/AIP050212.pdf>).

Alternative Analysis (AA) evaluation of the BMPs is a structured evaluation of BMPs that are reasonable and cost effective. The AA evaluation should include practices that are designed to be: 1) non-degrading; 2) less degrading; or 3) degrading water quality. The glossary of AIP defines these three terms. The chosen BMP will be the most reasonable and effective management strategy while ensuring the highest statutory and regulatory requirements are achieved and the highest quality water attainable for the facility is discharged. The AA evaluation must demonstrate why “no discharge” or “no exposure” is not a feasible alternative at the facility. This structured analysis of BMPs serves as the antidegradation review, fulfilling the requirements of 10 CSR 20-7.031(3) Water Quality Standards and *Antidegradation Implementation Procedure* (AIP), Section II.B.

If parameter-specific numeric exceedances continue to occur and the permittee feels there are no practicable or cost-effective BMPs which will sufficiently reduce a pollutant concentration in the discharge to the benchmark values established in the permit, the permittee can submit a request to re-evaluate the benchmark values. This request needs to include 1) a detailed explanation of why the facility is unable to comply with the permit conditions and unable to establish BMPs to achieve the benchmark values; 2) financial data of the company and documentation of cost associated with BMPs for review and 3) the SWPPP, which should contain adequate documentation of BMPs employed, failed BMPs, corrective actions, and all other required information. This will allow the department to conduct a cost analysis on control measures and actions taken by the facility to determine cost-effectiveness of BMPs. The request shall be submitted in the form of an operating permit modification; the application is found at: <http://dnr.mo.gov/forms/index.html>.

✓ Not applicable; at this time, the permittee is not required to develop and implement a SWPPP.

**VARIANCE:**

Per the Missouri Clean Water Law §644.061.4, variances shall be granted for such period of time and under such terms and conditions as shall be specified by the commission in its order. The variance may be extended by affirmative action of the commission. In no event shall the variance be granted for a period of time greater than is reasonably necessary for complying with the Missouri Clean Water Law §§644.006 to 644.141 or any standard, rule or regulation promulgated pursuant to Missouri Clean Water Law §§644.006 to 644.141.

✓ Not applicable; this permit is not drafted under premise of a petition for variance.

**WASTELOAD ALLOCATIONS (WLA) FOR LIMITS:**

As per [10 CSR 20-2.010(78)], the WLA is the amount of pollutant each discharger is allowed to discharge into the receiving stream without endangering water quality. Two general types of effluent limitations, technology-based effluent limits (TBELs) and water quality based effluent limits (WQBELs) are reviewed. If one limit does provide adequate protection for the receiving waters, then the other must be used.

✓ Applicable; wasteload allocations were calculated where relevant using water quality criteria or water quality model results and by applying the dilution equation below:

$$C = \frac{(C_s \times Q_s) + (C_e \times Q_e)}{(Q_e + Q_s)} \quad \text{(EPA/505/2-90-001, Section 4.5.5)}$$

Where C = downstream concentration  
 Cs = upstream concentration  
 Qs = upstream flow  
 Ce = effluent concentration  
 Qe = effluent flow

- Acute wasteload allocations designated as daily maximum limits (MDL) were determined using applicable water quality criteria (CMC: criteria maximum concentration) and stream volume of flow at the edge of the zone of initial dilution (ZID).
- Chronic wasteload allocations designated as monthly average limits (AML) were determined using applicable chronic water quality criteria (CCC: criteria continuous concentration) and stream volume of flow at the edge of the mixing zone (MZ).
- Water quality based MDL and AML effluent limitations were calculated using methods and procedures outlined in USEPA’s *Technical Support Document For Water Quality-based Toxics Control* or TSD EPA/505/2-90-001; 3/1991.
- Number of Samples “n”: In accordance with the TSD for water quality-based permitting, effluent quality is determined by the underlying distribution of daily values, which is determined by the Long Term Average (LTA) associated with a particular Wasteload Allocation (WLA) and by the Coefficient of Variation (CV) of the effluent concentrations. Increasing or decreasing the monitoring frequency does not affect this underlying distribution or treatment performance which should be, at a minimum, targeted to comply with the values dictated by the WLA. Therefore, it is recommended the actual planned frequency of monitoring normally be used to determine the value of “n” for calculating the AML. However, in situations where monitoring frequency is once per month or less, a higher value for “n” must be assumed for AML derivation purposes. Thus, the statistical procedure being employed using an assumed number of samples is “n = 4” at a minimum. For total ammonia as nitrogen, “n = 30” is used.

**WLA MODELING:**

Permittees may submit site specific studies to better determine the site specific wasteload allocations applied in permits.

✓ Not applicable; a WLA study was either not submitted or determined not applicable by department staff.

**WATER QUALITY STANDARDS:**

Per 10 CSR 20-7.031(4), general criteria shall be applicable to all waters of the state at all times including mixing zones. Additionally, 40 CFR 122.44(d)(1) directs the department to establish in each NPDES permit to include conditions to achieve water quality established under Section 303 of the Clean Water Act, including state narrative criteria for water quality.

**WHOLE EFFLUENT TOXICITY (WET) TEST:**

A WET test is a quantifiable method to determine discharges from the facility cause toxicity to aquatic life by itself, in combination with, or through synergistic responses, when mixed with receiving stream water.

✓ Not applicable; at this time, the permittee is not required to conduct WET testing for this facility.

**Part IV. EFFLUENT LIMITS DETERMINATION**

Effluent limitations derived and established in the below effluent limitations table are based on current operations of the facility. Effluent means both process water and stormwater. Any flow through the outfall is considered a discharge and must be sampled and reported as provided below. Future permit action due to facility modification may contain new operating permit terms and conditions that supersede the terms and conditions, including effluent limitations, of this operating permit. Daily maximums and monthly averages are required under 40 CFR 122.45(d)(1) for continuous discharges not from a POTW.

**GENERAL CRITERIA CONSIDERATIONS:**

In accordance with 40 CFR 122.44(d)(1), effluent limitations shall be placed into permits for pollutants which have been determined to cause, have the reasonable potential to cause, or to contribute to an excursion above any State water quality standard, including State narrative criteria for water quality. The rule further states pollutants which have been determined to cause, have the reasonable potential to cause, or contribute to an excursion above a narrative criterion within an applicable State water quality standard, the permit shall contain a numeric effluent limitation to protect that narrative criterion. The previous permit included the narrative criteria as specific prohibitions placed upon the discharge. These prohibitions were included in the permit absent any discussion of the discharge's reasonable potential to cause or contribute to an excursion of the criterion. In order to comply with this regulation, the permit writer has completed a reasonable potential determination on whether the discharge has reasonable potential to cause, or contribute to an excursion of the general criteria listed in 10 CSR 20-7.031(4). These specific requirements are listed below followed by derivation and discussion (the lettering matches that of the rule itself, under 10 CSR 20-7.031(4)). In instances where reasonable potential exists, the permit includes numeric limitations to address the reasonable potential. In instances where reasonable potential does not exist the permit includes monitoring of the discharges potential to impact the receiving stream's narrative criteria. Finally, all of the previous permit narrative criteria prohibitions have been removed from the permit given they are addressed by numeric limits where reasonable potential exists. It should also be noted that Section 644.076.1, RSMo as well as Section D – Administrative Requirements of Standard Conditions Part I of this permit state that it shall be unlawful for any person to cause or permit any discharge of water contaminants from any water contaminant or point source located in Missouri that is in violation of sections 644.006 to 644.141 of the Missouri Clean Water Law or any standard, rule, or regulation promulgated by the commission.

- (A) Waters shall be free from substances in sufficient amounts to cause the formation of putrescent, unsightly or harmful bottom deposits or prevent full maintenance of beneficial uses.
- For all outfalls, there is no RP for putrescent bottom deposits preventing full maintenance of beneficial uses because nothing disclosed by the permittee at renewal for these outfalls indicates putrescent wastewater would be discharged from the facility.
  - For all outfalls, there is no RP for unsightly or harmful bottom deposits preventing full maintenance of beneficial uses because all outfalls have TSS limitations, however, they are all based on technology for the processes involved; values discharged from all outfalls are typically below WQ limitations, therefore no RP.
- (B) Waters shall be free from oil, scum and floating debris in sufficient amounts to be unsightly or prevent full maintenance of beneficial uses.
- For all outfalls, there is no RP for oil in sufficient amounts to be unsightly preventing full maintenance of beneficial uses because nothing disclosed by the permittee at renewal or during prior sampling for DMR requirements for these outfalls indicates oil will be present in sufficient amounts to impair beneficial uses. In addition, technology based limitations are continued from the previous permit.
  - For all outfalls, there is no RP for scum and floating debris in sufficient amounts to be unsightly preventing full maintenance of beneficial uses because nothing disclosed by the permittee at renewal for these outfalls indicates scum and floating debris will be present in sufficient amounts to impair beneficial uses.
- (C) Waters shall be free from substances in sufficient amounts to cause unsightly color or turbidity, offensive odor or prevent full maintenance of beneficial uses.

- For all outfalls, there is no RP for unsightly color or turbidity in sufficient amounts preventing full maintenance of beneficial uses because nothing disclosed by the permittee at renewal for these outfalls indicates unsightly color or turbidity will be present in sufficient amounts to impair beneficial uses.
- For all outfalls, there is no RP for offensive odor in sufficient amounts preventing full maintenance of beneficial uses because nothing disclosed by the permittee at renewal for these outfalls indicates offensive odor will be present in sufficient amounts to impair beneficial uses.

- (D) Waters shall be free from substances or conditions in sufficient amounts to result in toxicity to human, animal or aquatic life.
- The permit writer considered specific toxic pollutants when writing this permit. Numeric effluent limitations are included for those pollutants that could be discharged in toxic amounts. These effluent limitations are protective of human health, animals, and aquatic life.
- (E) There shall be no significant human health hazard from incidental contact with the water.
- It is the permit writer's opinion that this criterion is the same as (D).
- (F) There shall be no acute toxicity to livestock or wildlife watering.
- It is the permit writer's opinion that this criterion is the same as (D).
- (G) Waters shall be free from physical, chemical or hydrologic changes that would impair the natural biological community.
- For all outfalls, there is no RP for physical or hydrologic changes that would impair the natural biological community because nothing disclosed by the permittee at renewal for these outfalls indicates physical or hydrologic changes that would impair the natural biological community.
  - It has previously been established that any chemical changes are covered by the specific numeric effluent limitations established in the permit.
- (H) Waters shall be free from used tires, car bodies, appliances, demolition debris, used vehicles or equipment and solid waste as defined in Missouri's Solid Waste Law, section 260.200, RSMo, except as the use of such materials is specifically permitted pursuant to section 260.200-260.247.
- There are no solid waste disposal activities or any operation that has reasonable potential to cause or contribute to the materials listed above being discharged through any outfall.

**OUTFALL #001 – MAIN FACILITY OUTFALL**

**EFFLUENT LIMITATIONS TABLE:**

PARAMETERS	UNIT	BASIS FOR LIMITS	DAILY MAX	MONTHLY AVG	PREVIOUS PERMIT LIMITS	MINIMUM SAMPLING FREQUENCY	MINIMUM REPORTING FREQUENCY	SAMPLE TYPE
PHYSICAL								
FLOW	MGD	1	*	*	SAME	ONCE/QUARTER	ONCE/QUARTER	24 HR. TOT
CONVENTIONAL								
COD	MG/L	6	90	60	SAME	ONCE/QUARTER	ONCE/QUARTER	GRAB
OIL & GREASE	MG/L	6	15	10	SAME	ONCE/QUARTER	ONCE/QUARTER	GRAB
pH †	SU	1, 3	6.5 TO 9.0	6.5 to 9.0	SAME	ONCE/QUARTER	ONCE/QUARTER	GRAB
TSS	MG/L	6	45	30	SAME	ONCE/QUARTER	ONCE/QUARTER	GRAB
METALS								
IRON, TOTAL RECOVERABLE	µg/L	1, 2, 3, 6	1850	682	1671.2/529.1	ONCE/QUARTER	ONCE/QUARTER	GRAB
OTHER								
CHLORIDE	MG/L	1,2,3,6	359	195	377.8/188.3	ONCE/QUARTER	ONCE/QUARTER	GRAB

- \* Monitoring requirement only
- † The facility will report the minimum and maximum pH values; pH is not to be averaged.
- NEW Parameter not previously established in previous state operating permit.

**Basis for Limitations Codes:**

1. State or Federal Regulation/Law
2. Water Quality Standard (includes RPA)
3. Water Quality Based Effluent Limits
4. Antidegradation Review/Policy
5. Water Quality Model
6. Best Professional Judgment
7. TMDL or Permit in lieu of TMDL
8. WET Test Policy

## DERIVATION AND DISCUSSION OF LIMITS:

### PHYSICAL:

#### Flow

In accordance with [40 CFR Part 122.44(i)(1)(ii)] the volume of effluent discharged from each outfall is needed to assure compliance with permitted effluent limitations. If the permittee is unable to obtain effluent flow, then it is the responsibility of the permittee to inform the department, which may require the submittal of an operating permit modification. The facility will report the total flow in millions of gallons per day (MGD).

### CONVENTIONAL:

#### Chemical Oxygen Demand (COD)

Daily maximum limit of 90 mg/L, with a monthly average limit of 60 mg/L. This limit is continued from the previous permit. There is no water quality standard for COD; however, increased oxygen demand may impact instream water quality. COD is also a valuable indicator parameter. COD monitoring allows the permittee to identify increases in COD that may indicate materials/chemicals coming into contact with stormwater that cause an increase in oxygen demand. Increases in COD may indicate a need for maintenance or improvement of treatment mechanisms. The permit writer uses best professional judgment to determine these technology based limitations are applicable to this facility and are therefore continued. The permit writer can find no justification to remove these limits under anti-backsliding.

#### Oil & Grease

Daily maximum limit of 15 mg/L, with a monthly average limit of 10 mg/L, continued from the previous permit. The DMR data shows these are achievable technology based limits for this facility, and are thus continued from the previous permit. Oil and grease is a conventional pollutant. Oil and grease is a comprehensive test which measures for gasoline, diesel, crude oil, creosote, kerosene, heating oils, heavy fuel oils, lubricating oils, waxes, and some asphalt and pitch. Fuels and oils are a pollutant of concern at this site. The oil and grease test can also detect some volatile organics such as benzene, toluene, ethylbenzene, or toluene, but these constituents are often lost during testing due to their boiling points. It is recommended to perform separate testing for these constituents if they are a known pollutant of concern at the site, i.e. aquatic life toxicity or human health is a concern. Results do not allow for separation of specific pollutants within the test, they are reported, totaled, as "Oil and grease". Per 10 CSR 20-7.031 Table A: *Criteria for Designated Uses*; 10 mg/L is the chronic standard for this parameter for protection of aquatic life. 10 mg/L is the level at which sheen is estimated to form on receiving waters. Oils and greases of different densities will possibly form sheen or unsightly bottom deposits at levels which vary from 10 mg/L. To protect the general criteria, it is the responsibility of the permittee to visually observe the discharge and receiving waters for sheen or bottom deposits.

The daily maximum was calculated using the *Technical Support Document for Water Quality-Based Toxics Control* (EPA/505/2-90-001). Section 5.4.2 indicates the waste load allocation can be set to the chronic standard. When the chronic standard is multiplied by 1.5, the daily maximum can be calculated. Hence,  $10 * 1.5 = 15$  mg/L for the daily maximum.

#### pH

6.5 to 9.0 SU. The Water Quality Standard at 10 CSR 20-7.031(5)(E) states water contaminants shall not cause pH to be outside the range of 6.5 to 9.0 standard pH units.

#### Total Suspended Solids (TSS)

Daily maximum limit of 45 mg/L with a monthly average limit of 30 mg/L. These limits are retained from the previous permit. DMR data from this facility shows these limits are achievable by the technology used by the facility. There were no exceedances in the previous permit cycle. The permit writer finds no justification to remove these limits under anti-backsliding.

### METALS:

Effluent limitations for total recoverable metals were developed using methods and procedures outlined in the *Technical Support Document For Water Quality-based Toxic Controls* (EPA/505/2-90-001) and *The Metals Translator: Guidance For Calculating a Total Recoverable Permit Limit From a Dissolved Criterion* (EPA 823-B-96-007). General warm-water habitat criteria apply (WWH) designated as AQL in 10 CSR 20-7.031 Table A. Additional use criterion (HHP, DWS, GRW, IRR, or LWV) may also be used as applicable to determine the most protective effluent limit for the stream class and uses.

When ambient site specific hardness data is not available, standard water hardness of 162 mg/L is used in the conversion below. This value represents the 25<sup>th</sup> percentile of all watershed's in-stream hardness values throughout Missouri. Additionally, when there are no site specific translator studies, partitioning between the dissolved and absorbed phases is assumed minimal (Section 5.7.3, EPA/505/2-90-001). Freshwater criteria conversion factors for dissolved metals were used as the metals translator as recommended in guidance (Section 1.3, 1.5.3, and Table 1, EPA 823-B-96-007). If concurrent site-specific data for total recoverable metals, dissolved metals, hardness, and total suspended solids are provided to the department, the department may integrate those findings into derivation of the water quality limits. Conversion factors for Cd and Pb are hardness dependent. N/A means not applicable.



METAL	CONVERSION FACTORS USING HARDNESS OF 162 MG/L	
	ACUTE	CHRONIC
Iron	N/A	N/A

**Iron, Total Recoverable**

Daily maximum limit of 1850 µg/L, with a monthly average limit of 682 µg/L. The previous permit required a daily maximum limit of 1671.2 µg/L, with a monthly average limit of 529.1 µg/L. The limits are increased with this permit due to using site specific DMR data to calculate limits. An RPA found reasonable potential to exceed water quality standards found at 10 CSR 20-7.031 Table A, therefore limits are retained.

See Part III, Reasonable Potential Analysis for more information on the calculation of limits.

Acute AQL WQS: none  
 Chronic AQL WQS: 1000  
 LTA<sub>a</sub>: none [CV = 1.22, 99<sup>th</sup> Percentile]  
 LTA<sub>c</sub>: 1000 (0.31669) = 316.6975 [CV = 1.22, 99<sup>th</sup> Percentile]  
 Use most protective number of LTA<sub>a</sub> or LTA<sub>c</sub>.  
 MDL: 316.6975 (5.8403) = 1849.6 = **1850 µg/L** [CV = 1.22, 99<sup>th</sup> Percentile]  
 AML: 316.6975 (2.1531) = 681.88 = **682 µg/L** [CV = 1.22, 95<sup>th</sup> Percentile, n = 21]

**OTHER:**

**Chloride**

Daily maximum limit of 359 mg/L, with a monthly average limit of 195 mg/L. The previous permit required a daily maximum limit of 377.8 mg/L, with a monthly average limit of 188.3 mg/L. The daily maximum limits are decreased and the monthly average limit has increased. This is due to site specific DMR data being used to calculate limits. An RPA found reasonable potential to exceed water quality standards found at 10 CSR 20-7.031 Table A, therefore limits are retained.

See Part III, Reasonable Potential Analysis for more information on the calculation of limits. No schedule of compliance is offered for this parameter, as DMR data shows the facility can meet the new effluent limits.

Acute AQL WQS: 860 mg/L  
 Chronic AQL WQS: 230 mg/L  
 LTA<sub>a</sub>: 860 (0.371) = 319.06 [CV = 0.5, 99<sup>th</sup> Percentile]  
 LTA<sub>c</sub>: 230 (0.580) = 133.4 [CV = 0.5, 99<sup>th</sup> Percentile]  
 Use most protective number of LTA<sub>a</sub> or LTA<sub>c</sub>.  
 MDL: 133.4 (2.69) = 358.846 = **359 µg/L** [CV = 0.5, 99<sup>th</sup> Percentile]  
 AML: 133.4 (1.46) = 194.76 = **195 µg/L** [CV = 0.5, 95<sup>th</sup> Percentile, n = 21]

**Part V. SAMPLING AND REPORTING REQUIREMENTS:**

Refer to each outfall's derivation and discussion of limits section to review individual sampling and reporting frequencies and sampling type. Additionally, see Standard Conditions Part I attached at the end of this permit and fully incorporated within.

**ELECTRONIC DISCHARGE MONITORING REPORT (EDMR) SUBMISSION SYSTEM:**

The U.S. Environmental Protection Agency (EPA) promulgated a final rule on October 22, 2015, to modernize Clean Water Act reporting for municipalities, industries, and other facilities by converting to an electronic data reporting system. This final rule requires regulated entities and state and federal regulators to use information technology to electronically report data required by the National Pollutant Discharge Elimination System (NPDES) permit program instead of filing paper reports. To comply with the federal rule, the Department is requiring all permittees to begin submitting discharge monitoring data and reports online.

Per 40 CFR 127.15 and 127.24, permitted facilities may request a temporary waiver for up to 5 years or a permanent waiver from electronic reporting from the Department. To obtain an electronic reporting waiver, a permittee must first submit an eDMR Waiver Request Form: <http://dnr.mo.gov/forms/780-2692-f.pdf>. A request must be made for each facility. If more than one facility is owned or operated by a single entity, then the entity must submit a separate request for each facility based on its specific circumstances. An approved waiver is non-transferable.

The Department must review and notify the facility within 120 calendar days of receipt if the waiver request has been approved or rejected [40 CFR 124.27(a)]. During the Department review period as well as after a waiver is granted, the facility must continue

submitting a hard-copy of any reports required by their permit. The Department will enter data submitted in hard-copy from those facilities allowed to do so and electronically submit the data to the EPA on behalf of the facility.

- ✓ The permittee/facility is not currently using the eDMR data reporting system. The permittee shall submit an eDMR Permit Holder and Certifier Registration form within **90 days** of the effective date of this permit.

**SAMPLING FREQUENCY JUSTIFICATION:**

Sampling and reporting frequency was generally retained from previous permit. 40 CFR 122.45(d)(1) indicates all continuous discharges shall be permitted with daily maximum and monthly average limits. The facility may sample more frequently if additional data is required to determine if best management operations and technology are performing as expected.

**SAMPLING TYPE JUSTIFICATION:**

Sampling type was continued from the previous permit. The sampling types are representative of the discharges, and are protective of water quality. Discharges with altering effluent should have composite sampling; discharges with uniform effluent can have grab samples. Grab samples are usually appropriate for stormwater. Parameters which must have grab sampling are: pH, ammonia, *E. coli*, total residual chlorine, free available chlorine, hexavalent chromium, dissolved oxygen, total phosphorus, and volatile organic samples.

**SUFFICIENTLY SENSITIVE ANALYTICAL METHODS:**

Please review Standard Conditions Part 1, section A, number 4. The analytical and sampling methods used shall conform to the reference methods listed in 10 CSR 20-7.015 and/or 40 CFR 136 unless alternates are approved by the department. The facility shall use sufficiently sensitive analytical methods for detecting, identifying, and measuring the concentrations of pollutants. The facility shall ensure the selected methods are able to quantify the presence of pollutants in a given discharge at concentrations that are low enough to determine compliance with Water Quality Standards in 10 CSR 20-7.031 or effluent limitations unless provisions in the permit allow for other alternatives. A method is “sufficiently sensitive” when; 1) the method quantifies the pollutant below the level of the applicable water quality criterion or; 2) the method minimum level is above the applicable water quality criterion, but the amount of pollutant in a facility’s discharge is high enough that the method detects and quantifies the level of pollutant in the discharge, or 3) the method has the lowest minimum level of the analytical methods approved under 10 CSR 20-7.015 and or 40 CFR 136. These methods are also required for parameters listed as monitoring only, as the data collected may be used to determine if numeric limitations need to be established. A permittee is responsible for working with their contractors to ensure the analysis performed is sufficiently sensitive. 40 CFR 136 lists the approved methods accepted by the department. Table A at 10 CFR 20-7.031 shows water quality standards.

**Part VI. ADMINISTRATIVE REQUIREMENTS**

On the basis of preliminary staff review and the application of applicable standards and regulations, the Department, as administrative agent for the Missouri Clean Water Commission, proposes to issue a permit(s) subject to certain effluent limitations, schedules, and special conditions contained herein and within the operating permit. The proposed determinations are tentative pending public comment.

**PERMIT SYNCHRONIZATION:**

The Department of Natural Resources is currently undergoing a synchronization process for operating permits. Permits are normally issued on a five-year term, but to achieve synchronization many permits will need to be issued for less than the full five years allowed by regulation. The intent is that all permits within a watershed will move through the Watershed Based Management (WBM) cycle together will all expire in the same fiscal year. <http://dnr.mo.gov/env/wpp/cpp/docs/watershed-based-management.pdf>. This will allow further streamlining by placing multiple permits within a smaller geographic area on public notice simultaneously, thereby reducing repeated administrative efforts. This will also allow the department to explore a watershed based permitting effort at some point in the future. Renewal applications must continue to be submitted within 180 days of expiration, however, in instances where effluent data from the previous renewal is less than three years old, that data may be re-submitted to meet the requirements of the renewal application. If the permit provides a schedule of compliance for meeting new water quality based effluent limits beyond the expiration date of the permit, the time remaining in the schedule of compliance will be allotted in the renewed permit.

- ✓ *This permit will become synchronized by expiring the end of the 3<sup>rd</sup> quarter, 2019.*

**PUBLIC NOTICE:**

The Department shall give public notice that a draft permit has been prepared and its issuance is pending. <http://dnr.mo.gov/env/wpp/permits/pn/index.html> Additionally, public notice will be issued if a public hearing is to be held because of a significant degree of interest in and water quality concerns related to a draft permit. No public notice is required when a request for a permit modification or termination is denied; however, the requester and permittee must be notified of the denial in writing.

The Department must issue public notice of a pending operating permit or of a new or reissued statewide general permit. The public comment period is the length of time not less than 30 days following the date of the public notice which interested persons may submit written comments about the proposed permit.

For persons wanting to submit comments regarding this proposed operating permit, then please refer to the Public Notice page located at the front of this draft operating permit. The Public Notice page gives direction on how and where to submit appropriate comments.

- The Public Notice period for this operating permit is tentatively scheduled to begin on (DATE) or is in process.

**DATE OF FACT SHEET:** 06/15/2017

**COMPLETED BY:**

AMBERLY SCHULZ, ENVIRONMENTAL SPECIALIST  
MISSOURI DEPARTMENT OF NATURAL RESOURCES  
WATER PROTECTION PROGRAM  
OPERATING PERMITS SECTION - INDUSTRIAL UNIT  
(573) 751-8049  
Amberly.schulz@dnr.mo.gov

DRAFT



STANDARD CONDITIONS FOR NPDES PERMITS  
ISSUED BY  
THE MISSOURI DEPARTMENT OF NATURAL RESOURCES  
MISSOURI CLEAN WATER COMMISSION  
REVISED  
AUGUST 1, 2014

These Standard Conditions incorporate permit conditions as required by 40 CFR 122.41 or other applicable state statutes or regulations. These minimum conditions apply unless superseded by requirements specified in the permit.

## Part I – General Conditions

### Section A – Sampling, Monitoring, and Recording

1. **Sampling Requirements.**
  - a. Samples and measurements taken for the purpose of monitoring shall be representative of the monitored activity.
  - b. All samples shall be taken at the outfall(s) or Missouri Department of Natural Resources (Department) approved sampling location(s), and unless specified, before the effluent joins or is diluted by any other body of water or substance.
2. **Monitoring Requirements.**
  - a. Records of monitoring information shall include:
    - i. The date, exact place, and time of sampling or measurements;
    - ii. The individual(s) who performed the sampling or measurements;
    - iii. The date(s) analyses were performed;
    - iv. The individual(s) who performed the analyses;
    - v. The analytical techniques or methods used; and
    - vi. The results of such analyses.
  - b. If the permittee monitors any pollutant more frequently than required by the permit at the location specified in the permit using test procedures approved under 40 CFR Part 136, or another method required for an industry-specific waste stream under 40 CFR subchapters N or O, the results of such monitoring shall be included in the calculation and reported to the Department with the discharge monitoring report data (DMR) submitted to the Department pursuant to Section B, paragraph 7.
3. **Sample and Monitoring Calculations.** Calculations for all sample and monitoring results which require averaging of measurements shall utilize an arithmetic mean unless otherwise specified in the permit.
4. **Test Procedures.** The analytical and sampling methods used shall conform to the reference methods listed in 10 CSR 20-7.015 unless alternates are approved by the Department. The facility shall use sufficiently sensitive analytical methods for detecting, identifying, and measuring the concentrations of pollutants. The facility shall ensure that the selected methods are able to quantify the presence of pollutants in a given discharge at concentrations that are low enough to determine compliance with Water Quality Standards in 10 CSR 20-7.031 or effluent limitations unless provisions in the permit allow for other alternatives. A method is “sufficiently sensitive” when; 1) the method minimum level is at or below the level of the applicable water quality criterion for the pollutant or, 2) the method minimum level is above the applicable water quality criterion, but the amount of pollutant in a facility’s discharge is high enough that the method detects and quantifies the level of pollutant in the discharge, or 3) the method has the lowest minimum level of the analytical methods approved under 10 CSR 20-7.015. These methods are also required for parameters that are listed as monitoring only, as the data collected may be used to determine if limitations need to be established. A permittee is responsible for working with their contractors to ensure that the analysis performed is sufficiently sensitive.
5. **Record Retention.** Except for records of monitoring information required by the permit related to the permittee’s sewage sludge use and disposal activities, which shall be retained for a period of at least five (5) years (or longer as required by 40 CFR part 503), the permittee shall retain records of all monitoring information, including all calibration and maintenance records and all original strip chart recordings for continuous monitoring instrumentation, copies of all reports required by the permit, and records of all data used to complete the application for the permit, for a period of at least three (3) years from the date of the sample, measurement, report or application. This period may be extended by request of the Department at any time.

6. **Illegal Activities.**
  - a. The Federal Clean Water Act provides that any person who falsifies, tampers with, or knowingly renders inaccurate any monitoring device or method required to be maintained under the permit shall, upon conviction, be punished by a fine of not more than \$10,000, or by imprisonment for not more than two (2) years, or both. If a conviction of a person is for a violation committed after a first conviction of such person under this paragraph, punishment is a fine of not more than \$20,000 per day of violation, or by imprisonment of not more than four (4) years, or both.
  - b. The Missouri Clean Water Law provides that any person or who falsifies, tampers with, or knowingly renders inaccurate any monitoring device or method required to be maintained pursuant to sections 644.006 to 644.141 shall, upon conviction, be punished by a fine of not more than \$10,000, or by imprisonment for not more than six (6) months, or by both. Second and successive convictions for violation under this paragraph by any person shall be punished by a fine of not more than \$50,000 per day of violation, or by imprisonment for not more than two (2) years, or both.

### Section B – Reporting Requirements

1. **Planned Changes.**
  - a. The permittee shall give notice to the Department as soon as possible of any planned physical alterations or additions to the permitted facility when:
    - i. The alteration or addition to a permitted facility may meet one of the criteria for determining whether a facility is a new source in 40 CFR 122.29(b); or
    - ii. The alteration or addition could significantly change the nature or increase the quantity of pollutants discharged. This notification applies to pollutants which are subject neither to effluent limitations in the permit, nor to notification requirements under 40 CFR 122.42;
    - iii. The alteration or addition results in a significant change in the permittee’s sludge use or disposal practices, and such alteration, addition, or change may justify the application of permit conditions that are different from or absent in the existing permit, including notification of additional use or disposal sites not reported during the permit application process or not reported pursuant to an approved land application plan;
  - iv. Any facility expansions, production increases, or process modifications which will result in a new or substantially different discharge or sludge characteristics must be reported to the Department 60 days before the facility or process modification begins. Notification may be accomplished by application for a new permit. If the discharge does not violate effluent limitations specified in the permit, the facility is to submit a notice to the Department of the changed discharge at least 30 days before such changes. The Department may require a construction permit and/or permit modification as a result of the proposed changes at the facility.
2. **Non-compliance Reporting.**
  - a. The permittee shall report any noncompliance which may endanger health or the environment. Relevant information shall be provided orally or via the current electronic method approved by the Department, within 24 hours from the time the permittee becomes aware of the circumstances, and shall be reported to the appropriate Regional Office during normal business hours or the Environmental Emergency Response hotline at 573-634-2436 outside of normal business hours. A written submission shall also be provided within five (5) business days of the time the permittee becomes aware of the circumstances. The written submission shall contain a description of the noncompliance and its cause; the period of noncompliance, including exact dates and times, and if the noncompliance has not been corrected, the anticipated time it is expected to continue; and steps taken or planned to reduce, eliminate, and prevent reoccurrence of the noncompliance.



STANDARD CONDITIONS FOR NPDES PERMITS  
ISSUED BY  
THE MISSOURI DEPARTMENT OF NATURAL RESOURCES  
MISSOURI CLEAN WATER COMMISSION  
REVISED  
AUGUST 1, 2014

- b. The following shall be included as information which must be reported within 24 hours under this paragraph.
    - i. Any unanticipated bypass which exceeds any effluent limitation in the permit.
    - ii. Any upset which exceeds any effluent limitation in the permit.
    - iii. Violation of a maximum daily discharge limitation for any of the pollutants listed by the Department in the permit required to be reported within 24 hours.
  - c. The Department may waive the written report on a case-by-case basis for reports under paragraph 2. b. of this section if the oral report has been received within 24 hours.
3. **Anticipated Noncompliance.** The permittee shall give advance notice to the Department of any planned changes in the permitted facility or activity which may result in noncompliance with permit requirements. The notice shall be submitted to the Department 60 days prior to such changes or activity.
  4. **Compliance Schedules.** Reports of compliance or noncompliance with, or any progress reports on, interim and final requirements contained in any compliance schedule of the permit shall be submitted no later than 14 days following each schedule date. The report shall provide an explanation for the instance of noncompliance and a proposed schedule or anticipated date, for achieving compliance with the compliance schedule requirement.
  5. **Other Noncompliance.** The permittee shall report all instances of noncompliance not reported under paragraphs 2, 3, and 6 of this section, at the time monitoring reports are submitted. The reports shall contain the information listed in paragraph 2. a. of this section.
  6. **Other Information.** Where the permittee becomes aware that it failed to submit any relevant facts in a permit application, or submitted incorrect information in a permit application or in any report to the Department, it shall promptly submit such facts or information.
  7. **Discharge Monitoring Reports.**
    - a. Monitoring results shall be reported at the intervals specified in the permit.
    - b. Monitoring results must be reported to the Department via the current method approved by the Department, unless the permittee has been granted a waiver from using the method. If the permittee has been granted a waiver, the permittee must use forms provided by the Department.
    - c. Monitoring results shall be reported to the Department no later than the 28<sup>th</sup> day of the month following the end of the reporting period.
- b. Notice.
    - i. Anticipated bypass. If the permittee knows in advance of the need for a bypass, it shall submit prior notice, if possible at least 10 days before the date of the bypass.
    - ii. Unanticipated bypass. The permittee shall submit notice of an unanticipated bypass as required in Section B – Reporting Requirements, paragraph 5 (24-hour notice).
  - c. Prohibition of bypass.
    - i. Bypass is prohibited, and the Department may take enforcement action against a permittee for bypass, unless:
      1. Bypass was unavoidable to prevent loss of life, personal injury, or severe property damage;
      2. There were no feasible alternatives to the bypass, such as the use of auxiliary treatment facilities, retention of untreated wastes, or maintenance during normal periods of equipment downtime. This condition is not satisfied if adequate back-up equipment should have been installed in the exercise of reasonable engineering judgment to prevent a bypass which occurred during normal periods of equipment downtime or preventive maintenance; and
      3. The permittee submitted notices as required under paragraph 2. b. of this section.
    - ii. The Department may approve an anticipated bypass, after considering its adverse effects, if the Department determines that it will meet the three (3) conditions listed above in paragraph 2. c. i. of this section.
3. **Upset Requirements.**
    - a. Effect of an upset. An upset constitutes an affirmative defense to an action brought for noncompliance with such technology based permit effluent limitations if the requirements of paragraph 3. b. of this section are met. No determination made during administrative review of claims that noncompliance was caused by upset, and before an action for noncompliance, is final administrative action subject to judicial review.
    - b. Conditions necessary for a demonstration of upset. A permittee who wishes to establish the affirmative defense of upset shall demonstrate, through properly signed, contemporaneous operating logs, or other relevant evidence that:
      - i. An upset occurred and that the permittee can identify the cause(s) of the upset;
      - ii. The permitted facility was at the time being properly operated; and
      - iii. The permittee submitted notice of the upset as required in Section B – Reporting Requirements, paragraph 2. b. ii. (24-hour notice).
      - iv. The permittee complied with any remedial measures required under Section D – Administrative Requirements, paragraph 4.
    - c. Burden of proof. In any enforcement proceeding, the permittee seeking to establish the occurrence of an upset has the burden of proof.

## Section C – Bypass/Upset Requirements

1. **Definitions.**
  - a. *Bypass*: the intentional diversion of waste streams from any portion of a treatment facility, except in the case of blending.
  - b. *Severe Property Damage*: substantial physical damage to property, damage to the treatment facilities which causes them to become inoperable, or substantial and permanent loss of natural resources which can reasonably be expected to occur in the absence of a bypass. Severe property damage does not mean economic loss caused by delays in production.
  - c. *Upset*: an exceptional incident in which there is unintentional and temporary noncompliance with technology based permit effluent limitations because of factors beyond the reasonable control of the permittee. An upset does not include noncompliance to the extent caused by operational error, improperly designed treatment facilities, inadequate treatment facilities, lack of preventive maintenance, or careless or improper operation.
2. **Bypass Requirements.**
  - a. Bypass not exceeding limitations. The permittee may allow any bypass to occur which does not cause effluent limitations to be exceeded, but only if it also is for essential maintenance to assure efficient operation. These bypasses are not subject to the provisions of paragraphs 2. b. and 2. c. of this section.

## Section D – Administrative Requirements

1. **Duty to Comply.** The permittee must comply with all conditions of this permit. Any permit noncompliance constitutes a violation of the Missouri Clean Water Law and Federal Clean Water Act and is grounds for enforcement action; for permit termination, revocation and reissuance, or modification; or denial of a permit renewal application.
  - a. The permittee shall comply with effluent standards or prohibitions established under section 307(a) of the Federal Clean Water Act for toxic pollutants and with standards for sewage sludge use or disposal established under section 405(d) of the CWA within the time provided in the regulations that establish these standards or prohibitions or standards for sewage sludge use or disposal, even if the permit has not yet been modified to incorporate the requirement.
  - b. The Federal Clean Water Act provides that any person who violates section 301, 302, 306, 307, 308, 318 or 405 of the Act, or any permit condition or limitation implementing any such sections in a permit issued under section 402, or any requirement imposed in a pretreatment program approved under sections 402(a)(3) or 402(b)(8) of the Act, is subject to a civil penalty not to exceed \$25,000 per day for each violation. The Federal Clean Water Act provides that any person who negligently violates sections 301, 302, 306, 307, 308, 318, or 405 of the Act, or any condition or limitation implementing any of such sections in a permit issued under section 402 of the Act, or any requirement



STANDARD CONDITIONS FOR NPDES PERMITS  
ISSUED BY  
THE MISSOURI DEPARTMENT OF NATURAL RESOURCES  
MISSOURI CLEAN WATER COMMISSION  
REVISED  
AUGUST 1, 2014

- imposed in a pretreatment program approved under section 402(a)(3) or 402(b)(8) of the Act, is subject to criminal penalties of \$2,500 to \$25,000 per day of violation, or imprisonment of not more than one (1) year, or both. In the case of a second or subsequent conviction for a negligent violation, a person shall be subject to criminal penalties of not more than \$50,000 per day of violation, or by imprisonment of not more than two (2) years, or both. Any person who knowingly violates such sections, or such conditions or limitations is subject to criminal penalties of \$5,000 to \$50,000 per day of violation, or imprisonment for not more than three (3) years, or both. In the case of a second or subsequent conviction for a knowing violation, a person shall be subject to criminal penalties of not more than \$100,000 per day of violation, or imprisonment of not more than six (6) years, or both. Any person who knowingly violates section 301, 302, 303, 306, 307, 308, 318 or 405 of the Act, or any permit condition or limitation implementing any of such sections in a permit issued under section 402 of the Act, and who knows at that time that he thereby places another person in imminent danger of death or serious bodily injury, shall, upon conviction, be subject to a fine of not more than \$250,000 or imprisonment of not more than 15 years, or both. In the case of a second or subsequent conviction for a knowing endangerment violation, a person shall be subject to a fine of not more than \$500,000 or by imprisonment of not more than 30 years, or both. An organization, as defined in section 309(c)(3)(B)(iii) of the CWA, shall, upon conviction of violating the imminent danger provision, be subject to a fine of not more than \$1,000,000 and can be fined up to \$2,000,000 for second or subsequent convictions.
- c. Any person may be assessed an administrative penalty by the EPA Director for violating section 301, 302, 306, 307, 308, 318 or 405 of this Act, or any permit condition or limitation implementing any of such sections in a permit issued under section 402 of this Act. Administrative penalties for Class I violations are not to exceed \$10,000 per violation, with the maximum amount of any Class I penalty assessed not to exceed \$25,000. Penalties for Class II violations are not to exceed \$10,000 per day for each day during which the violation continues, with the maximum amount of any Class II penalty not to exceed \$125,000.
- d. It is unlawful for any person to cause or permit any discharge of water contaminants from any water contaminant or point source located in Missouri in violation of sections 644.006 to 644.141 of the Missouri Clean Water Law, or any standard, rule or regulation promulgated by the commission. In the event the commission or the director determines that any provision of sections 644.006 to 644.141 of the Missouri Clean Water Law or standard, rules, limitations or regulations promulgated pursuant thereto, or permits issued by, or any final abatement order, other order, or determination made by the commission or the director, or any filing requirement pursuant to sections 644.006 to 644.141 of the Missouri Clean Water Law or any other provision which this state is required to enforce pursuant to any federal water pollution control act, is being, was, or is in imminent danger of being violated, the commission or director may cause to have instituted a civil action in any court of competent jurisdiction for the injunctive relief to prevent any such violation or further violation or for the assessment of a penalty not to exceed \$10,000 per day for each day, or part thereof, the violation occurred and continues to occur, or both, as the court deems proper. Any person who willfully or negligently commits any violation in this paragraph shall, upon conviction, be punished by a fine of not less than \$2,500 nor more than \$25,000 per day of violation, or by imprisonment for not more than one year, or both. Second and successive convictions for violation of the same provision of this paragraph by any person shall be punished by a fine of not more than \$50,000 per day of violation, or by imprisonment for not more than two (2) years, or both.
2. **Duty to Reapply.**
- a. If the permittee wishes to continue an activity regulated by this permit after the expiration date of this permit, the permittee must apply for and obtain a new permit.
- b. A permittee with a currently effective site-specific permit shall submit an application for renewal at least 180 days before the expiration date of the existing permit, unless permission for a later date has been granted by the Department. (The Department shall not grant permission for applications to be submitted later than the expiration date of the existing permit.)
- c. A permittees with currently effective general permit shall submit an application for renewal at least 30 days before the existing permit expires, unless the permittee has been notified by the Department that an earlier application must be made. The Department may grant permission for a later submission date. (The Department shall not grant permission for applications to be submitted later than the expiration date of the existing permit.)
3. **Need to Halt or Reduce Activity Not a Defense.** It shall not be a defense for a permittee in an enforcement action that it would have been necessary to halt or reduce the permitted activity in order to maintain compliance with the conditions of this permit.
4. **Duty to Mitigate.** The permittee shall take all reasonable steps to minimize or prevent any discharge or sludge use or disposal in violation of this permit which has a reasonable likelihood of adversely affecting human health or the environment.
5. **Proper Operation and Maintenance.** The permittee shall at all times properly operate and maintain all facilities and systems of treatment and control (and related appurtenances) which are installed or used by the permittee to achieve compliance with the conditions of this permit. Proper operation and maintenance also includes adequate laboratory controls and appropriate quality assurance procedures. This provision requires the operation of back-up or auxiliary facilities or similar systems which are installed by a permittee only when the operation is necessary to achieve compliance with the conditions of the permit.
6. **Permit Actions.**
- a. Subject to compliance with statutory requirements of the Law and Regulations and applicable Court Order, this permit may be modified, suspended, or revoked in whole or in part during its term for cause including, but not limited to, the following:
- i. Violations of any terms or conditions of this permit or the law;
- ii. Having obtained this permit by misrepresentation or failure to disclose fully any relevant facts;
- iii. A change in any circumstances or conditions that requires either a temporary or permanent reduction or elimination of the authorized discharge; or
- iv. Any reason set forth in the Law or Regulations.
- b. The filing of a request by the permittee for a permit modification, revocation and reissuance, or termination, or a notification of planned changes or anticipated noncompliance does not stay any permit condition.
7. **Permit Transfer.**
- a. Subject to 10 CSR 20-6.010, an operating permit may be transferred upon submission to the Department of an application to transfer signed by the existing owner and the new owner, unless prohibited by the terms of the permit. Until such time the permit is officially transferred, the original permittee remains responsible for complying with the terms and conditions of the existing permit.
- b. The Department may require modification or revocation and reissuance of the permit to change the name of the permittee and incorporate such other requirements as may be necessary under the Missouri Clean Water Law or the Federal Clean Water Act.
- c. The Department, within 30 days of receipt of the application, shall notify the new permittee of its intent to revoke or reissue or transfer the permit.
8. **Toxic Pollutants.** The permittee shall comply with effluent standards or prohibitions established under section 307(a) of the Federal Clean Water Act for toxic pollutants and with standards for sewage sludge use or disposal established under section 405(d) of the Federal Clean Water Act within the time provided in the regulations that establish these standards or prohibitions or standards for sewage sludge use or disposal, even if the permit has not yet been modified to incorporate the requirement.
9. **Property Rights.** This permit does not convey any property rights of any sort, or any exclusive privilege.



STANDARD CONDITIONS FOR NPDES PERMITS  
ISSUED BY  
THE MISSOURI DEPARTMENT OF NATURAL RESOURCES  
MISSOURI CLEAN WATER COMMISSION  
REVISED  
AUGUST 1, 2014

10. **Duty to Provide Information.** The permittee shall furnish to the Department, within a reasonable time, any information which the Department may request to determine whether cause exists for modifying, revoking and reissuing, or terminating this permit or to determine compliance with this permit. The permittee shall also furnish to the Department upon request, copies of records required to be kept by this permit.
11. **Inspection and Entry.** The permittee shall allow the Department, or an authorized representative (including an authorized contractor acting as a representative of the Department), upon presentation of credentials and other documents as may be required by law, to:
  - a. Enter upon the permittee's premises where a regulated facility or activity is located or conducted, or where records must be kept under the conditions of the permit;
  - b. Have access to and copy, at reasonable times, any records that must be kept under the conditions of this permit;
  - c. Inspect at reasonable times any facilities, equipment (including monitoring and control equipment), practices, or operations regulated or required under this permit; and
  - d. Sample or monitor at reasonable times, for the purposes of assuring permit compliance or as otherwise authorized by the Federal Clean Water Act or Missouri Clean Water Law, any substances or parameters at any location.
12. **Closure of Treatment Facilities.**
  - a. Persons who cease operation or plan to cease operation of waste, wastewater, and sludge handling and treatment facilities shall close the facilities in accordance with a closure plan approved by the Department.
  - b. Operating Permits under 10 CSR 20-6.010 or under 10 CSR 20-6.015 are required until all waste, wastewater, and sludges have been disposed of in accordance with the closure plan approved by the Department and any disturbed areas have been properly stabilized. Disturbed areas will be considered stabilized when perennial vegetation, pavement, or structures using permanent materials cover all areas that have been disturbed. Vegetative cover, if used, shall be at least 70% plant density over 100% of the disturbed area.
13. **Signatory Requirement.**
  - a. All permit applications, reports required by the permit, or information requested by the Department shall be signed and certified. (See 40 CFR 122.22 and 10 CSR 20-6.010)
  - b. The Federal Clean Water Act provides that any person who knowingly makes any false statement, representation, or certification in any record or other document submitted or required to be maintained under this permit, including monitoring reports or reports of compliance or non-compliance shall, upon conviction, be punished by a fine of not more than \$10,000 per violation, or by imprisonment for not more than six (6) months per violation, or by both.
  - c. The Missouri Clean Water Law provides that any person who knowingly makes any false statement, representation or certification in any application, record, report, plan, or other document filed or required to be maintained pursuant to sections 644.006 to 644.141 shall, upon conviction, be punished by a fine of not more than ten thousand dollars, or by imprisonment for not more than six months, or by both.
14. **Severability.** The provisions of the permit are severable, and if any provision of the permit, or the application of any provision of the permit to any circumstance, is held invalid, the application of such provision to other circumstances, and the remainder of the permit, shall not be affected thereby.

SEP 08 2015

AP 21802



MISSOURI DEPARTMENT OF NATURAL RESOURCES  
 WATER PROTECTION PROGRAM  
**FORM A – APPLICATION FOR NONDOMESTIC PERMIT UNDER MISSOURI  
 CLEAN WATER LAW**

FOR AGENCY USE ONLY	
CHECK NUMBER	
DATE RECEIVED	FEE SUBMITTED
9/5/15	0

**Note** PLEASE READ THE ACCOMPANYING INSTRUCTIONS BEFORE COMPLETING THIS FORM.

1. This application is for:

An operating permit for a new or unpermitted facility:  
 Please indicate the original Construction Permit # \_\_\_\_\_

An operating permit renewal:  
 Please indicate the permit # MO- 0115215 Expiration Date March 31, 2016

An operating permit modification:  
 Please indicate the permit # MO- \_\_\_\_\_ Modification Reason: \_\_\_\_\_

1.1 Is the appropriate fee included with the application? (See instructions for appropriate fee)  YES  NO

**2. FACILITY**

NAME Panhandle Eastern Pipe Line Co., Centralia Compressor Station		TELEPHONE NUMBER WITH AREA CODE (573) 682-3041	
		FAX (573) 682-6204	
ADDRESS (PHYSICAL) 16151 North Route Z	CITY Centralia	STATE MO	ZIP CODE 65240

**3. OWNER**

NAME Panhandle Eastern Pipe Line Company		TELEPHONE NUMBER WITH AREA CODE (913) 906-1560	
		FAX (913) 906-1509	
ADDRESS (MAILING) 7500 College Blvd., Suite 300	CITY Overland Park	STATE KS	ZIP CODE 66210

3.1 Request review of draft permit prior to public notice?  YES  NO

**4. CONTINUING AUTHORITY**

NAME Panhandle Eastern Pipe Line Company		TELEPHONE NUMBER WITH AREA CODE (913) 906-1560	
		FAX (913) 906-1509	
ADDRESS (MAILING) 7500 College Blvd., Suite 300	CITY Overland park	STATE KS	ZIP CODE 66210

**5. OPERATOR**

NAME Eric T. Coen		TELEPHONE NUMBER WITH AREA CODE (573) 682-6231	
		FAX (573) 682-6216	
ADDRESS (MAILING) 16151 North Route Z	CITY Centralia	STATE MO	ZIP CODE 65240

**6. FACILITY CONTACT**

NAME Steven Mitchell		TELEPHONE NUMBER WITH AREA CODE (913) 906-1560	
		FAX (913) 906-1509	
TITLE Division Environmental Specialist		E-MAIL ADDRESS steven.mitchell@energytransfer.co	

**7. ADDITIONAL FACILITY INFORMATION**

7.1 Legal Description of Outfalls. (Attach additional sheets if necessary.)

001 NE 1/4 NW 1/4 Sec 10 T 50 R 11 Boone County  
 UTM Coordinates Easting (X): \_\_\_\_\_ Northing (Y): \_\_\_\_\_  
*For Universal Transverse Mercator (UTM), Zone 15 North referenced to North American Datum 1983 (NAD83)*

002 NE 1/4 NW 1/4 Sec 10 T 50 R 11 Boone County  
 UTM Coordinates Easting (X): \_\_\_\_\_ Northing (Y): \_\_\_\_\_

003 \_\_\_\_\_ 1/4 \_\_\_\_\_ 1/4 Sec \_\_\_\_\_ T \_\_\_\_\_ R \_\_\_\_\_ County  
 UTM Coordinates Easting (X): \_\_\_\_\_ Northing (Y): \_\_\_\_\_

004 \_\_\_\_\_ 1/4 \_\_\_\_\_ 1/4 Sec \_\_\_\_\_ T \_\_\_\_\_ R \_\_\_\_\_ County  
 UTM Coordinates Easting (X): \_\_\_\_\_ Northing (Y): \_\_\_\_\_

7.2 Primary Standard Industrial Classification (SIC) and Facility North American Industrial Classification System (NAICS) Codes.

001 – SIC 4922 and NAICS 486210      002 – SIC \_\_\_\_\_ and NAICS \_\_\_\_\_  
 003 – SIC \_\_\_\_\_ and NAICS \_\_\_\_\_      004 – SIC \_\_\_\_\_ and NAICS \_\_\_\_\_

NE  
Boone



**8. ADDITIONAL FORMS AND MAPS NECESSARY TO COMPLETE THIS APPLICATION**  
**(Complete all forms that are applicable.)**

- A. Is your facility a manufacturing, commercial, mining or silviculture waste treatment facility? YES  NO   
 If yes, complete Form C or 2F.  
 (2F is the U.S. EPA's Application for Storm Water Discharges Associate with Industrial Activity.)
- B. Is application for storm water discharges only? YES  NO   
 If yes, complete Form C or 2F.
- C. Is your facility considered a "Primary Industry" under EPA guidelines: YES  NO   
 If yes, complete Forms C or 2F and D.
- D. Is wastewater land applied? YES  NO   
 If yes, complete Form I.
- E. Is sludge, biosolids, ash or residuals generated, treated, stored or land applied? YES  NO   
 If yes, complete Form R.
- F. If you are a Class IA CAFO, please disregard part D and E of this section. However, please attach any revision to your Nutrient Management Plan.
- F. Attach a map showing all outfalls and the receiving stream at 1" = 2,000' scale.

**9. DOWNSTREAM LANDOWNER(S)** Attach additional sheets as necessary. See Instructions.  
**(PLEASE SHOW LOCATION ON MAP. SEE 8.D ABOVE).**

NAME Betty Kroeger			
ADDRESS 12101 East Kroeger Road	CITY Centralia	STATE MO	ZIP CODE 65240

**10.** I certify that I am familiar with the information contained in the application, that to the best of my knowledge and belief such information is true, complete and accurate, and if granted this permit, I agree to abide by the Missouri Clean Water Law and all rules, regulations, orders and decisions, subject to any legitimate appeal available to applicant under the Missouri Clean Water Law to the Missouri Clean Water Commission.

NAME AND OFFICIAL TITLE (TYPE OR PRINT) Jim Kerns, Vice President, Operations	TELEPHONE NUMBER WITH AREA CODE (913) 906-1508
SIGNATURE 	DATE SIGNED 9/04/2015

MO 780-1479 (07-14)

**BEFORE MAILING, PLEASE ENSURE ALL SECTIONS ARE COMPLETED AND ADDITIONAL FORMS, IF APPLICABLE, ARE INCLUDED.**

Submittal of an incomplete application may result in the application being returned.

HAVE YOU INCLUDED:

- Appropriate Fees?
- Map at 1" = 2000' scale?
- Signature?
- Form C or 2F, if applicable?
- Form D, if applicable?
- Form I (Irrigation), if applicable?
- Form R (Sludge), if applicable?
- Revised Nutrient Management Plan, if applicable?

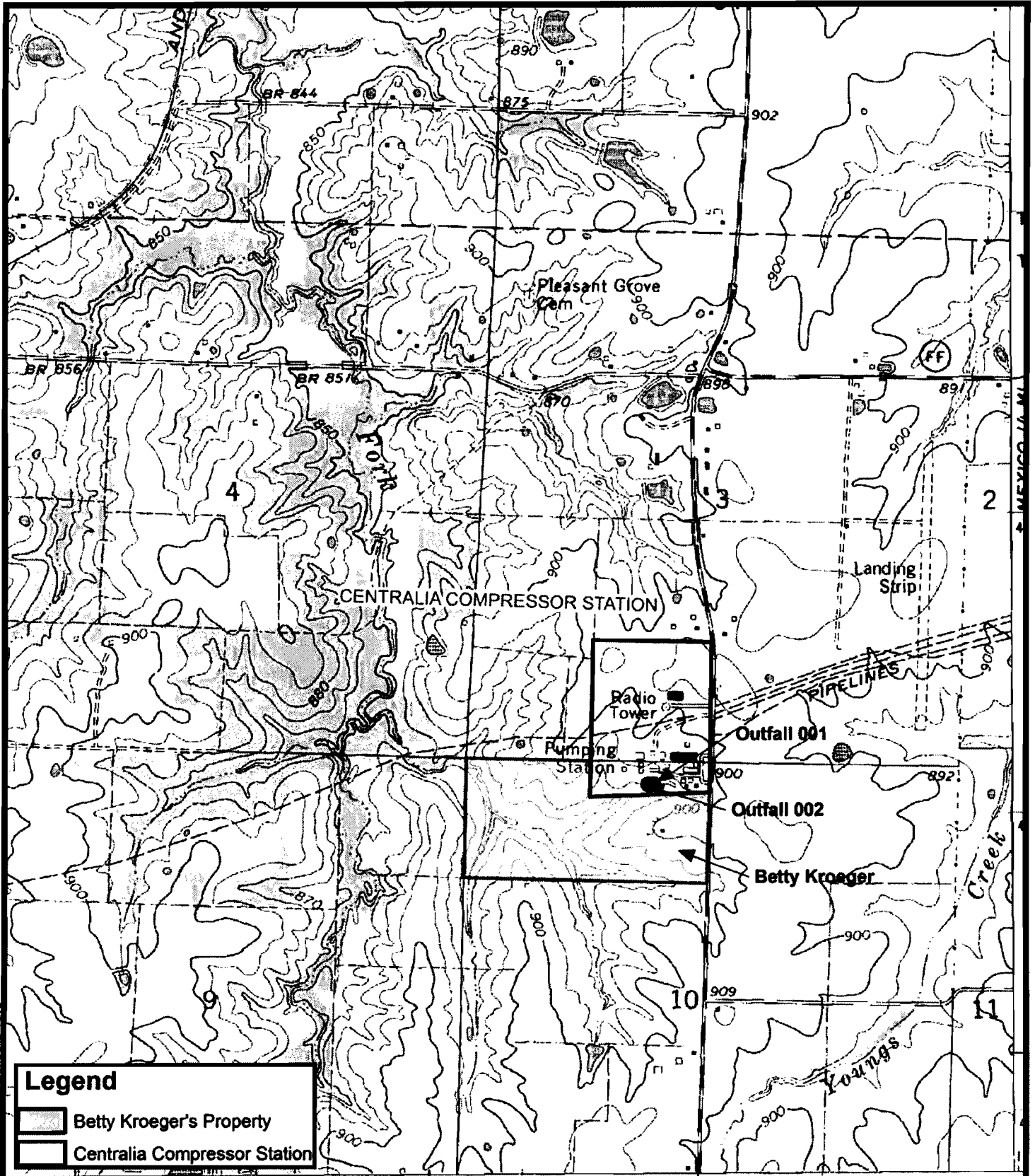

**Legend**

-  Betty Kroeger's Property
-  Centralia Compressor Station

**Source:**  
 USGS-Topographic Map, Centralia, MO  
 (7.5 min, 1969, Photorevised 1979)

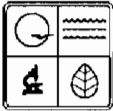

**EXHIBIT 2  
 LOCATION MAP**

**CENTRALIA COMPRESSOR STATION  
 BOONE COUNTY, MISSOURI**

S:\project\0246\DESIGN\GIS\Exhibit 1 Location Map\_Centralia\_rev3

RECEIVED  
SEP 08 2015



MISSOURI DEPARTMENT OF NATURAL RESOURCES Water Protection Program  
WATER PROTECTION PROGRAM, WATER POLLUTION BRANCH  
**FORM C – APPLICATION FOR DISCHARGE PERMIT –**  
**MANUFACTURING, COMMERCIAL, MINING,**  
**SILVICULTURE OPERATIONS, PROCESS AND STORMWATER**

FOR AGENCY USE ONLY	
CHECK NO.	
DATE RECEIVED	FEE SUBMITTED

**NOTE: DO NOT ATTEMPT TO COMPLETE THIS FORM BEFORE READING THE ACCOMPANYING INSTRUCTIONS**

1.00 NAME OF FACILITY  
Panhandle Eastern Pipe Line Company, Centralia Compressor Station

1.10 THIS FACILITY IS NOW IN OPERATION UNDER MISSOURI OPERATING PERMIT NUMBER  
MO-0115215

1.20 THIS IS A NEW FACILITY AND WAS CONSTRUCTED UNDER MISSOURI CONSTRUCTION PERMIT NUMBER (COMPLETE ONLY IF THIS FACILITY DOES NOT HAVE AN OPERATING PERMIT).  
Not Applicable (N/A)

2.00 LIST THE STANDARD INDUSTRIAL CLASSIFICATION (SIC) CODES APPLICABLE TO YOUR FACILITY (FOUR DIGIT CODE)  
A. FIRST 4922 - Natural Gas Transmission B. SECOND \_\_\_\_\_  
C. THIRD \_\_\_\_\_ D. FOURTH \_\_\_\_\_

2.10 FOR EACH OUTFALL GIVE THE LEGAL DESCRIPTION.  
OUTFALL NUMBER (LIST) NE 1/4 NW 1/4 SEC 10 T 50N R 11W Boone (Both Outfalls 001 & 002) COUNTY

OUTFALL NUMBER (LIST)	RECEIVING WATER
001 and 002* See Attachment 1	Silver Fork Stream

2.30 BRIEFLY DESCRIBE THE NATURE OF YOUR BUSINESS  
Panhandle Eastern Pipe Line Company is a natural gas transmission company. Natural gas is transported via underground pipelines to the northern states for heating and electrical generation purposes. Natural gas compressor stations function to compress the gas for further transport in the pipelines.

Panhandle Eastern Pipe Line Company  
Centralia NPDES Permit No. MO-0115215 Renewal Application

Attachment 1

Panhandle Eastern Pipe Line Company's (Panhandle) Centralia Station generates and discharges wastewater on-site under the authorization of Permit No. MO-0115215. The permit authorizes the discharge of wastewater from Outfalls 001 and 002. The discharge from Outfall 001 consists of treated wastewater from groundwater/stormwater infiltration into building basements, housekeeping wash water, water softener regeneration water, cooling water, and air compressor condensate that may come into contact with small quantities of oil. Treatment consists of oil/water separation, particle filtration, and filtration through clay/coal and activated carbon filters before discharge.

Outfall 002 is the discharge point from the accumulation of rainwater and melted snow from a concrete containment structure enclosing three 3,300-gallon wastewater holding tanks, which are part of the wastewater treatment system that treats the discharge from Outfall 001. Although this outfall was included in MDNR Permit No. MO-0115215, effective April 1, 2011, this outfall has never discharged, and past Discharge Monitoring Reports have been certified as "no discharge". Stormwater and snowmelt are pumped from within the containment structure into the first 3,300-gallon tank, Tank 17, for treatment and discharge through Outfall 001.

Panhandle has never discharged from Outfall 002, nor has any plans to do so, and has permanently locked and plugged the valve used to drain the containment structure. Therefore, Panhandle Eastern is requesting that Outfall 002 be eliminated from this permit.

Notes:

- 1) Outfall 001 - See Form C, Page 7, Panhandle has marked Aluminum, Magnesium, and Manganese as "Believed Present" since these elements are common constituents of groundwater infiltrating the building basements, and the municipal potable water provided to the site by Public Water Supply District No. 4.
- 2) Outfall 002 - Form C, Table 1 for 3.00 Item A and B is not provided since there was never any discharge from this outfall, and samples were never collected and analyzed.
- 3) Analysis for Chlorides - Long Term Average Concentration is 53.1 mg/L, and Long Term Average Discharge is 0.4300 lbs/day.

A. Attach a line drawing showing the water flow through the facility. Indicate sources of intake water, operations contributing wastewater to the effluent and treatment units labeled to correspond to the more detailed descriptions in item B. Construct a water balance on the line drawing by showing average flows between intakes, operations, treatment units, public sewers and outfalls. If a water balance cannot be determined (e.g., for certain mining activities), provide a pictorial description of the nature and amount of any sources of water and any collection or treatment measures.

B. For each outfall, provide a description of 1. All operations contributing wastewater to the effluent, including process wastewater, sanitary wastewater, cooling water and storm water runoff. 2. The average flow contributed by each operation. 3. The treatment received by the wastewater. Continue on additional sheets if necessary.

1. OUTFALL NO.  (LIST)	2. OPERATION(S) CONTRIBUTING FLOW		3. TREATMENT		
	A. OPERATION (LIST)	B. AVERAGE FLOW (INCLUDE UNITS) (MAXIMUM FLOW)	A. DESCRIPTION	B. LIST CODES FROM TABLE A	
001	Main Engine Room #1	Avg. Flow - 916 Gal/Day	Flotation	1-H	
	Groundwater Infiltration		Microstraining	1-N	
	Trace of Oil, Housekeeping		Carbon Absorption	2-A	
	Wash Water, Cooling Water				
	Auxiliary Building		Avg Flow - 50 Gal/Day	Flotation	1-H
	Groundwater Infiltration			Microstraining	1-N
	Trace Oil, Housekeeping			Carbon Absorption	2-A
	Wash Water, Air Compressor				
	Condensation, Water				
Softener Regeneration Water					
	Concrete Containment	Avg Flow - 5 Gal/Day	Flotation	1-H	
	for 3 oil/water separators		Microstraining	1-N	
			Carbon Absorption	2-A	
		Total Average Flow - 971 Gal/Day			
002	Concrete Containment for 3	Total Average Flow - 0 Gal/Day			
	Oil/Water Separator Tanks				
	(Stormwater Routed to				
	Treatment System & Outfall 1)				

TREATMENT UNIT LEGEND:

- 1-H FLOTATION
- 1-N MICROSTRAINING
- 2-A CARBON ABSORPTION

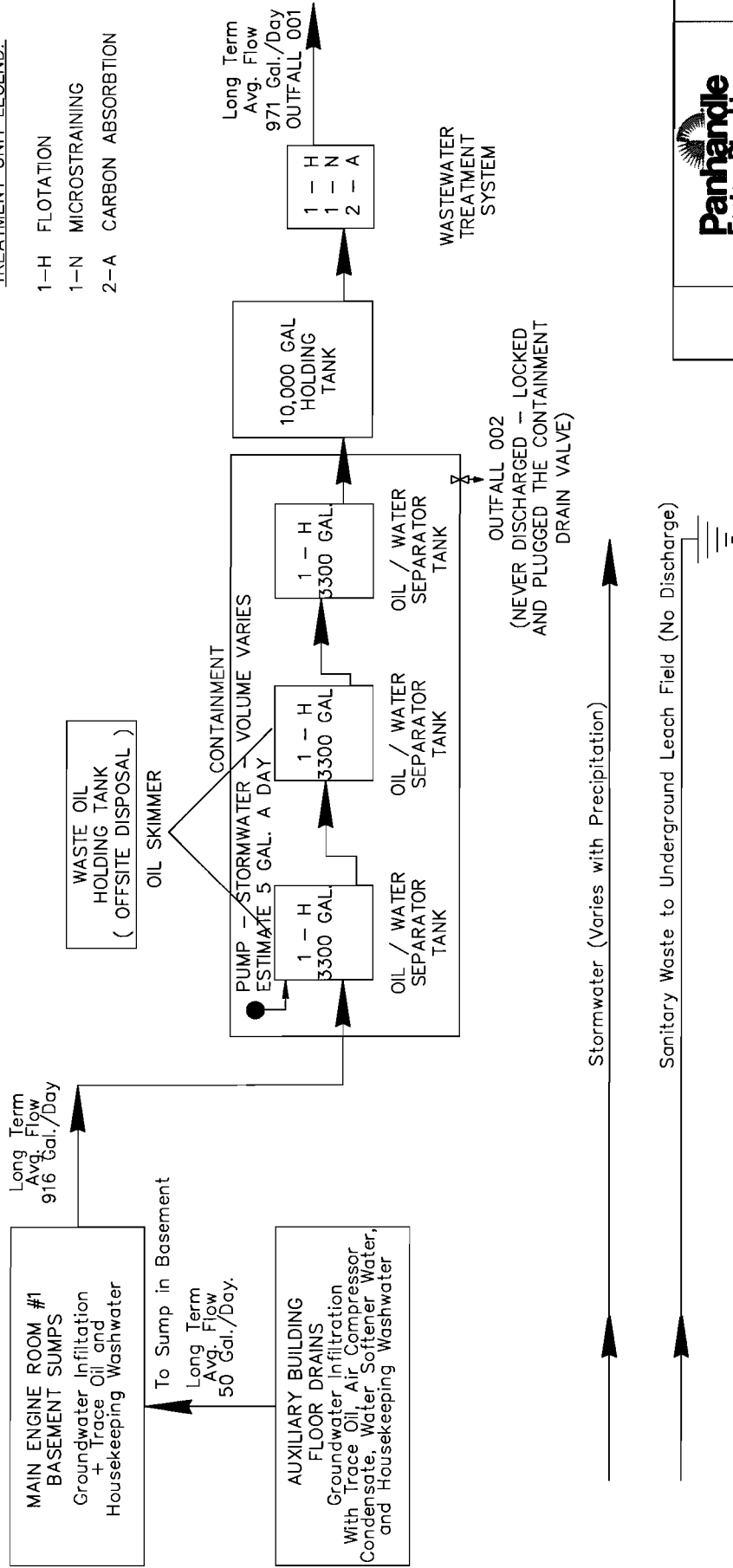

NOTE: Potable Water Provided by Public Water Supply District #4



Sanitary Waste to Underground Leach Field (No Discharge)

Stormwater (Varies with Precipitation)

OUTFALL 002 (NEVER DISCHARGED - LOCKED AND PLUGGED THE CONTAINMENT DRAIN VALVE)

WASTEWATER TREATMENT SYSTEM

Long Term Avg. Flow 971 Gal./Day OUTFALL 001

10,000 GAL HOLDING TANK

CONTAINMENT VOLUME VARIES

1 - H 3300 GAL

1 - H 3300 GAL

1 - H 3300 GAL

1 - H 3300 GAL

1 - H 3300 GAL



**FIGURE 1**  
 WATER FLOW SCHEMATIC  
 CENTRALIA COMPRESSOR STATION  
 CENTRALIA, MISSOURI

**2.40 CONTINUED**

C. EXCEPT FOR STORM RUNOFF, LEAKS OR SPILLS, ARE ANY OF THE DISCHARGES DESCRIBED IN ITEMS A OR B INTERMITTENT OR SEASONAL?

**YES (COMPLETE THE FOLLOWING TABLE)**       **NO (GO TO SECTION 2.50)**

1. OUTFALL NUMBER <i>(list)</i>	2. OPERATION(S) CONTRIBUTING FLOW <i>(list)</i>	3. FREQUENCY		4. FLOW				C. DURATION <i>(in days)</i>
		A. DAYS PER WEEK <i>(specify average)</i>	B. MONTHS PER YEAR <i>(specify average)</i>	A. FLOW RATE <i>(in mgd)</i>		B. TOTAL VOLUME <i>(specify with units)</i>		
				1. LONG TERM AVERAGE	2. MAXIMUM DAILY	4. LONG TERM DAILY	3. MAXIMUM AVERAGE	
001	Main Engine Room 1, Groundwater Infiltration, Housekeeping Washwater, Trace of Oil	4	12	0.000916	0.00683	916 gpd	6,831 gpd	3
	Auxiliary Building Floor Drains, Groundwater Infiltration with Trace of Oil, Air Compressor Condensate, Water Softener Water, and Housekeeping Washwater	4	12	0.00005	0.000373	50 gpd	373 gpd	3
	Containment Structure for 3 O/W Tanks	<1	4	0.000005	0.000037	5 gpd	37 gpd	1
002	Containment Structure for 3 O/W Tanks	0	0	0	0	0 gpd	0 gpd	N/A

**2.50 MAXIMUM PRODUCTION**

A. DOES AN EFFLUENT GUIDELINE LIMITATION PROMULGATED BY EPA UNDER SECTION 304 OF THE CLEAN WATER ACT APPLY TO YOUR FACILITY?

**YES (COMPLETE B.)**       **NO (GO TO SECTION 2.60)**

B. ARE THE LIMITATIONS IN THE APPLICABLE EFFLUENT GUIDELINES EXPRESSED IN TERMS OF PRODUCTION (OF OTHER MEASURE OF OPERATION)?

**YES (COMPLETE c.)**       **NO (GO TO SECTION 2.60)**

C. IF YOU ANSWERED "YES" TO B. LIST THE QUANTITY THAT REPRESENTS AN ACTUAL MEASUREMENT OF YOUR MAXIMUM LEVEL OF PRODUCTION, EXPRESSED IN THE TERMS AND UNITS USED IN THE APPLICABLE EFFLUENT GUIDELINE AND INDICATE THE AFFECTED OUTFALLS.

1. MAXIMUM QUANTITY			2. AFFECTED OUTFALLS <i>(list outfall numbers)</i>
A. QUANTITY PER DAY	B. UNITS OF MEASURE	C. OPERATION, PRODUCT, MATERIAL, ETC. <i>(specify)</i>	

**2.60 IMPROVEMENTS**

A. ARE YOU NOW REQUIRED BY ANY FEDERAL, STATE OR LOCAL AUTHORITY TO MEET, ANY IMPLEMENTATION SCHEDULE FOR THE CONSTRUCTION, UPGRADING OR OPERATION OF WASTEWATER TREATMENT EQUIPMENT OR PRACTICES OR ANY OTHER ENVIRONMENTAL PROGRAMS THAT MAY AFFECT THE DISCHARGES DESCRIBED IN THIS APPLICATION? THIS INCLUDES, BUT IS NOT LIMITED TO, PERMIT CONDITIONS, ADMINISTRATIVE OR ENFORCEMENT ORDERS, ENFORCEMENT COMPLIANCE SCHEDULE LETTERS, STIPULATIONS, COURT ORDERS AND GRANT OR LOAN CONDITIONS.

**YES (COMPLETE THE FOLLOWING TABLE)**       **NO (GO TO 3.00)**

1. IDENTIFICATION OF CONDITION AGREEMENT, ETC.	2. AFFECTED OUTFALLS		3. BRIEF DESCRIPTION OF PROJECT	4. FINAL COMPLIANCE DATE	
				A. REQUIRED	B. PROJECTED

B. OPTIONAL: YOU MAY ATTACH ADDITIONAL SHEETS DESCRIBING ANY ADDITIONAL WATER POLLUTION CONTROL PROGRAMS (OR OTHER ENVIRONMENTAL PROJECTS WHICH MAY AFFECT YOUR DISCHARGES) YOU NOW HAVE UNDER WAY OR WHICH YOU PLAN. INDICATE WHETHER EACH PROGRAM IS NOW UNDER WAY OR PLANNED, AND INDICATE YOUR ACTUAL OR PLANNED SCHEDULES FOR CONSTRUCTION.

**MARK "X" IF DESCRIPTION OF ADDITIONAL CONTROL PROGRAMS IS ATTACHED.**

3.00 INTAKE AND EFFLUENT CHARACTERISTICS

A. & B. SEE INSTRUCTIONS BEFORE PROCEEDING – COMPLETE ONE TABLE FOR EACH OUTFALL – ANNOTATE THE OUTFALL NUMBER IN THE SPACE PROVIDED.  
 NOTE: TABLE 1 IS INCLUDED ON SEPARATE SHEETS NUMBERED FROM PAGE 6 TO PAGE 7.

C. USE THE SPACE BELOW TO LIST ANY OF THE POLLUTANTS LISTED IN PART B OF THE INSTRUCTIONS, WHICH YOU KNOW OR HAVE REASON TO BELIEVE IS DISCHARGED OR MAY BE DISCHARGED FROM ANY OUTFALL. FOR EVERY POLLUTANT YOU LIST, BRIEFLY DESCRIBE THE REASONS YOU BELIEVE IT TO BE PRESENT AND REPORT ANY ANALYTICAL DATA IN YOUR POSSESSION.

1. POLLUTANT	2. SOURCE	1. POLLUTANT	2. SOURCE
Ourfall 001 - Oil & Grease	Small leaks from engines and		
	compressors. In 2014 and		
	2015 all samples were non-		
	detect at a reporting limit of		
	5 mg/L.		
Outfall 002	No Discharge		



3.10 BIOLOGICAL TOXICITY TESTING DATA

DO YOU HAVE ANY KNOWLEDGE OR REASON TO BELIEVE THAT ANY BIOLOGICAL TEST FOR ACUTE OR CHRONIC TOXICITY HAS BEEN MADE ON ANY OF YOUR DISCHARGES OR ON RECEIVING WATER IN RELATION TO YOUR DISCHARGE WITHIN THE LAST THREE YEARS?

YES (IDENTIFY THE TEST(S) AND DESCRIBE THEIR PURPOSES BELOW.)  NO (GO TO 3.20)

3.20 CONTRACT ANALYSIS INFORMATION

WERE ANY OF THE ANALYSES REPORTED PERFORMED BY A CONTRACT LABORATORY OR CONSULTING FIRM?

YES (LIST THE NAME, ADDRESS AND TELEPHONE NUMBER OF AND POLLUTANTS ANALYZED BY EACH SUCH LABORATORY OR FIRM BELOW.)  NO (GO TO 3.30)

A. NAME	B. ADDRESS	C. TELEPHONE (area code and number)	D. POLLUTANTS ANALYZED (list)
Pace Analytical Services, Inc.	9603 Loiret blvd, Lenexa, KS 66219	913-599-5665	BOD COD TOC TSS Ammonia as N Oil & Grease Iron Chlorides

3.30 CERTIFICATION

I CERTIFY UNDER PENALTY OF LAW THAT I HAVE PERSONALLY EXAMINED AND AM FAMILIAR WITH THE INFORMATION SUBMITTED IN THIS APPLICATION AND ALL ATTACHMENTS AND THAT, BASED ON MY INQUIRY OF THOSE INDIVIDUALS IMMEDIATELY RESPONSIBLE FOR OBTAINING THE INFORMATION, I BELIEVE THAT THE INFORMATION IS TRUE, ACCURATE AND COMPLETE. I AM AWARE THAT THERE ARE SIGNIFICANT PENALTIES FOR SUBMITTING FALSE INFORMATION, INCLUDING THE POSSIBILITY OF FINE AND IMPRISONMENT.

NAME AND OFFICIAL TITLE (TYPE OR PRINT) <b>Jim Kerns, Vice President Operations</b>	TELEPHONE NUMBER WITH AREA CODE <b>(913) 906-1508</b>
SIGNATURE (SEE INSTRUCTIONS)	DATE SIGNED

PLEASE PRINT OR TYPE. You may report some or all of this information on separate sheet  
(Use the same format) instead of completing these pages.  
SEE INSTRUCTIONS

FORM C  
TABLE 1 FOR 3.00 ITEM A AND B

INTAKE AND EFFLUENT CHARACTERISTICS

OUTFALL NO.  
001

PART A – You must provide the results of at least one analysis for every pollutant in this table. Complete one table for each outfall. See instructions for additional details.

1. POLLUTANT	2. EFFLUENT				3. UNITS (specify if blank)				4. INTAKE (optional)		B. NO. OF ANALYSES	
	A. MAXIMUM DAILY VALUE		B. MAXIMUM 30 DAY VALUE (if available)		C. LONG TERM AVRG. VALUE (if available)		D. NO. OF ANALYSES	A. CONCENTRATION	B. MASS	A. LONG TERM AVRG. VALUE		
	(1) CONCENTRATION	(2) MASS	(1) CONCENTRATION	(2) MASS	(1) CONCENTRATION	(2) MASS				(1) CONCENTRATION		(2) MASS
A. Biochemical Oxygen Demand (BOD)	<2.0	<0.1207					1	mg/L	lbs/day			
B. Chemical Oxygen Demand (COD)					<12.1	<0.0981	4	mg/L	lbs/day			
C. Total organic Carbon (TOC)	<1.0	<0.0603					1	mg/L	lbs/cay			
D. Total Suspended Solids (TSS)					<6.0	<0.0485	4	mg/L	lbs/day			
E. Ammonia (as N)	<0.10	<0.0060					1	mg/L	lbs/day			
F. Flow	VALUE	7,241 gal/day	VALUE		VALUE	971 gal/day				VALUE		
G. Temperature (winter)	VALUE	Ambient	VALUE		VALUE	Ambient				VALUE		
H. Temperature (summer)	VALUE	Ambient	VALUE		VALUE	Ambient				VALUE		
I. pH	MINIMUM 6.8	MAXIMUM 7.67	MINIMUM	MAXIMUM								

PART B – Mark "X" in column 2A for each pollutant you know or have reason to believe is present. Mark "X" in column 2B for each pollutant you believe to be absent. If you mark column 2A for any pollutant, you must provide the results for at least one analysis for that pollutant. Complete one table for each outfall. See the instructions for additional details and requirements.

1. POLLUTANT AND CAS NUMBER (if available)	2. MARK "X"		3. EFFLUENT				4. UNITS				5. INTAKE (optional)		
	A. BELIEVED PRESENT	B. BELIEVED ABSENT	A. MAXIMUM DAILY VALUE		B. MAXIMUM 30 DAY VALUE (if available)		C. LONG TERM AVRG. VALUE (if available)		D. NO. OF ANALYSES	A. CONCENTRATION	B. MASS	A. LONG TERM AVRG. VALUE	
			(1) CONCENTRATION	(2) MASS	(1) CONCENTRATION	(2) MASS	(1) CONCENTRATION	(2) MASS				(1) CONCENTRATION	(2) MASS
A. Bromide (24959-67-9)		X											
B. Chlorine, Total Residual		X											
C. Color		X											
D. Fecal Coliform		X											
E. Fluoride (16984-48-8)		X											
F. Nitrate - Nitrate (as N)		X											

CONVENTIONAL AND NONCONVENTIONAL POLLUTANTS

1. POLLUTANT AND CAS NUMBER (if available)	2. MARK "X"		3. EFFLUENT						4. UNITS			5. INTAKE (optional)		
	A. BELIEVED PRESENT	B. BELIEVED ABSENT	A. MAXIMUM DAILY VALUE (if available)		B. MAXIMUM 30 DAY VALUE (if available)		C. LONG TERM AVRG. VALUE (if available)		D. NO. OF ANALYSES	A. CONCENTRATION	B. MASS	A. LONG TERM AVRG. VALUE		B. NO. OF ANALYSES
			(1) CONCENTRATION	(2) MASS	(1) CONCENTRATION	(2) MASS	(1) CONCENTRATION	(2) MASS						
G. Nitrogen, Total Organic (as N)		X												
H. Oil and Grease		X									lbs/day			
I. Phosphorus (as P), Total (7723-14-0)		X												
J. Sulfate (as SO <sub>4</sub> ) (14808-79-8)		X												
K. Sulfide (as S)		X												
L. Sulfite (as SO <sub>3</sub> ) (14265-45-3)		X												
M. Surfactants		X												
N. Aluminum, Total (7429-90-5)	X													
O. Barium, Total (7440-39-3)		X												
P. Boron, Total (7440-42-8)		X												
Q. Cobalt, Total (7440-48-4)		X												
R. Iron, Total (7439-89-6)	X													
S. Magnesium, Total (7439-95-4)	X													
T. Molybdenum, Total (7439-98-7)		X												
U. Manganese, Total (7439-96-5)	X													
V. Tin, Total (7440-31-5)		X												
W. Titanium, Total (7440-32-6)		X												

1. POLLUTANT AND CAS NUMBER (if available)	2. MARK "X"		3. EFFLUENT						4. UNITS		5. INTAKE (optional)			
	A. BELIEVED PRESENT	B. BELIEVED ABSENT	A. MAXIMUM DAILY VALUE (if available)		B. MAXIMUM 30 DAY VALUE (if available)		C. LONG TERM AVRG. VALUE (if available)		D. NO. OF ANALYSES	A. CONCENTRATION	B. MASS	A. LONG TERM AVRG. VALUE		B. NO. OF ANALYSES
			(1) CONCENTRATION	(2) MASS	(1) CONCENTRATION	(2) MASS	(1) CONCENTRATION	(2) MASS						
<b>METALS, AND TOTAL PHENOLS</b>														
1M. Antimony, Total (7440-36-9)		X												
2M. Arsenic, Total (7440-38-2)		X												
3M. Beryllium, Total (7440-41-7)		X												
4M. Cadmium, Total (7440-43-9)		X												
5M. Chromium III (16065-83-1)		X												
6M. Chromium VI (18540-29-9)		X												
7M. Copper, Total (7440-50-8)		X												
8M. Lead, Total (7439-92-1)		X												
9M. Mercury, Total (7439-97-6)		X												
10M. Nickel, Total (7440-02-0)		X												
11M. Selenium, Total (7782-49-2)		X												
12M. Silver, Total (7440-22-4)		X												
13M. Thallium, Total (7440-28-0)		X												
14M. Zinc, Total (7440-66-6)		X												
15M. Cyanide, Amenable to Chlorination		X												
16M. Phenols, Total		X												
<b>RADIOACTIVITY</b>														
(1) Alpha Total		X												
(2) Beta Total		X												
(3) Radium Total		X												
(4) Radium 226 Total		X												